

The Capital Design Advisory Committee

Welcomes you to the open house

St. Mary's College of Maryland & Historic St. Mary's City

Anne Arundel Hall Replacement
Maryland Heritage Interpretive Center

- Architectural Concepts -

Academic Space Needs

The College and City seek to promote **collaborations and joint programming** between faculty, City staff, and students.

The Historic Campus provides 1/3 of total academic space. Academic Programs in the Historic Campus have a 21% space shortage.



The **Museum Studies** program, jointly created by the College and City in 2007, has grown to 24 students in its first two years.

The recently established **Martin E. Sullivan Scholars program** will further expand the Museum Studies program.

The Museum Studies program will benefit from **adjacencies to City archaeology labs and the Interpretive Center.**

The Need for a New Archaeological Laboratory & Curation Facilities

Current HSMC facility **does not meet standards** for archaeology or museum curation.

Renewal of HSMC's **accreditation is contingent** upon the construction of a new state-of-the-art facility.



Curation space in the current facility is **nearly full**

Five million artifacts and growing!

Insufficient space for archaeological analysis

Limited accessibility of artifacts by scholars and students

Co-locating HSMC archaeological programs with College academic programs is consistent with Senate Bill 393 of 1997 which called for **enhanced joint educational programming**



The Need for a New Visitors Center



Security and environmental systems are inadequate at the existing Visitors Center to allow HSMC to borrow valuable objects from other museums

The existing structure limits space layout and **adversely affects the visitor experience**

Limited space in the existing structure is insufficient for mounting a major permanent exhibit

The existing structure is **not visible from Route 5** making it difficult for some visitors to find

The opportunity to integrate archaeology with the visitor experience requires **adjacencies** between Anne Arundel Hall and the new Interpretive Center

Program

College Space

- Anthropology
- International Languages & Cultures
- Museum Studies
- Center for the Study of Democracy
- Blackistone Room
- General Classrooms

City Space

- Archaeological Research
- Library & archive storage
- Artifact collection & curation
- Offices

Interpretive Center

- Video orientation theater
- Permanent exhibit gallery
- Temporary exhibit space

Benefits of Co-Locating Academic, Curation, and Interpretation Programs

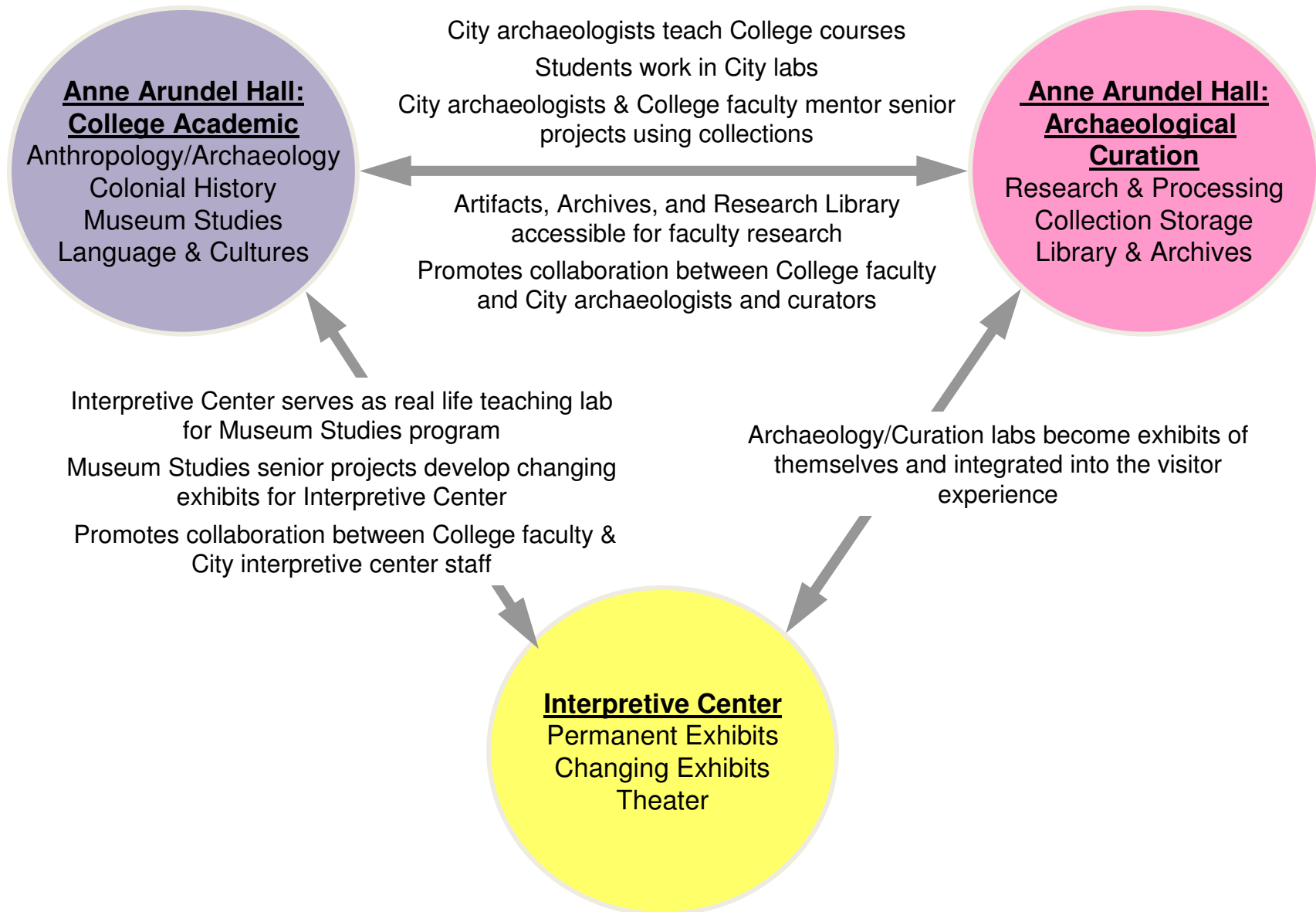

Why not Re-use the Existing Building?

The existing building is unfit for re-use for the following reasons:

INADEQUACIES:

- Structural capacity (floor loading)
- Exterior walls for environmental control
- Handicap accessibility (3 ground floor levels)



Re-using the existing building would sacrifice the following needs and goals:

PROGRAMMATIC:

- Designing unique spaces with optimal functionality
- Providing desired space adjacencies

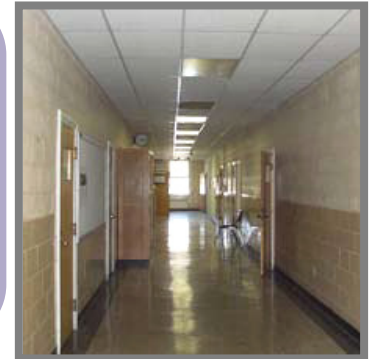

ENVIRONMENTAL IMPACT:

- 85%-90% of the materials need replacing (floors, windows, exterior walls, interiors)
- All equipment needs replacing (mechanical, electrical, plumbing)
- Cannot be as energy efficient as a new design

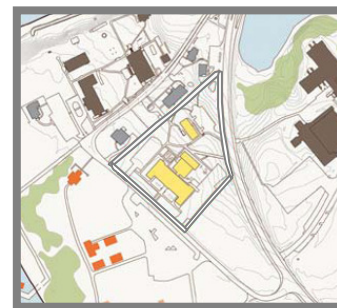

SITE DEVELOPMENT:

- Incorporating Middle Street
- Avoiding areas of higher archaeological sensitivity
- Reducing the impact on viewshed
- Creating “place”

Site Planning Principles

SITE DEVELOPMENT OBJECTIVES

- Create a place: a central courtyard
- Connect to Calvert/Kent Quad
- Provide a handicapped accessible path from Route 5 crosswalk
- Respect/Recognize Middle Street
- Create views to State House
- Manage building scale
- No primary building entrance from Route 5
- Preserve or relocate the herb garden

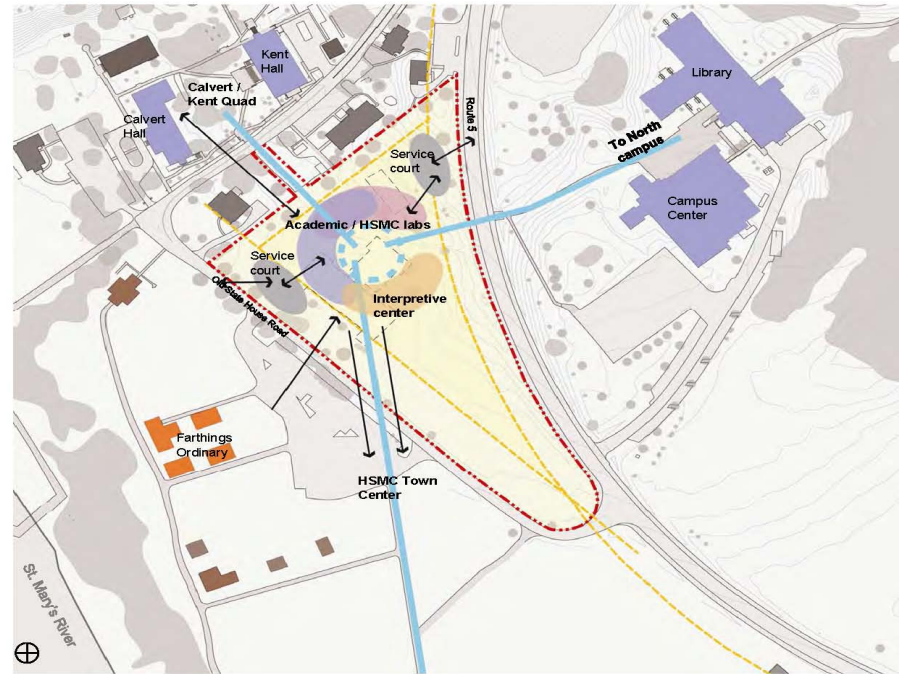

STEWARDSHIP GOALS

- Avoid/respect areas of high archaeological significance
- Protect/enhance existing environmental resources
 - Improve storm water management
 - Develop historic spring as a feature
 - Preserve existing trees where possible
- Preserve historic viewshed

Proposed Site Plan

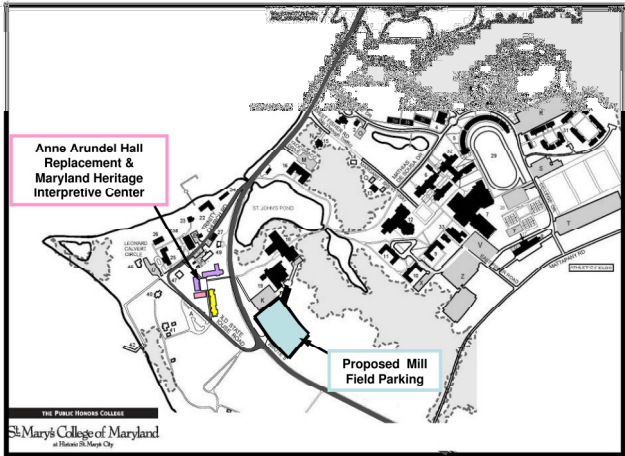
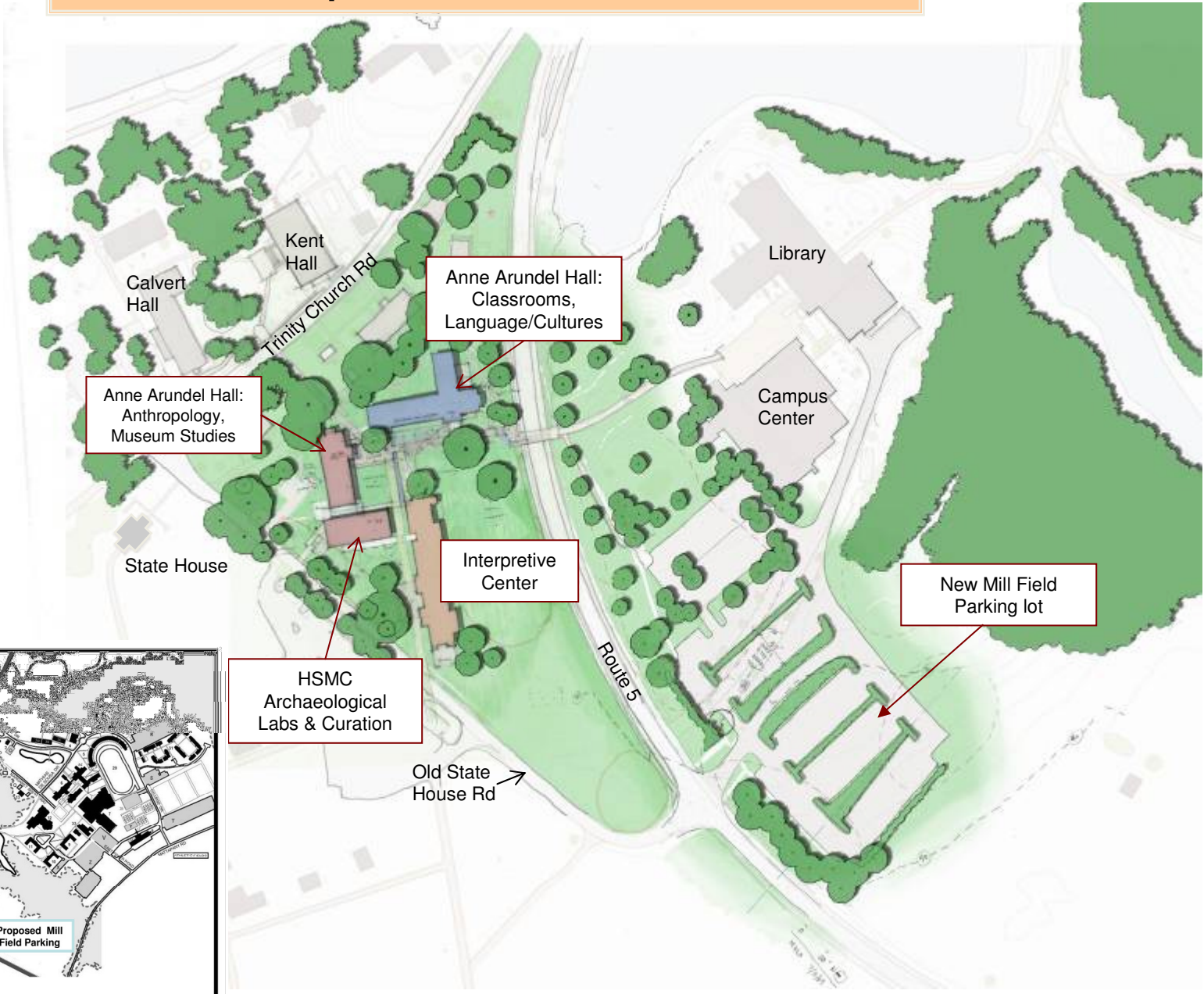

Avoid/Respect areas of higher archaeological significance

Archaeology for construction: A practiced process:

In accordance with State and Federal requirements:

- Step 1- Survey the site, identify archaeology and its significance
- Step 2 - Develop building plans that preserve/avoid archaeology to the extent possible
- Step 3 - If not possible, develop an archaeological mitigation plan to be **approved and permitted by the Maryland State Historical Trust**
- Step 4- Complete the excavations, then begin construction

Anne Arundel/MHIC project will:

- Follow **the same process**
- Salvage evidence disturbed in 1950s
- Leave about 90% of archaeology undisturbed



St. John's Site

- Excavated the remains of 6 buildings
- 992,000 artifacts recovered
- Archaeological foundation preserved

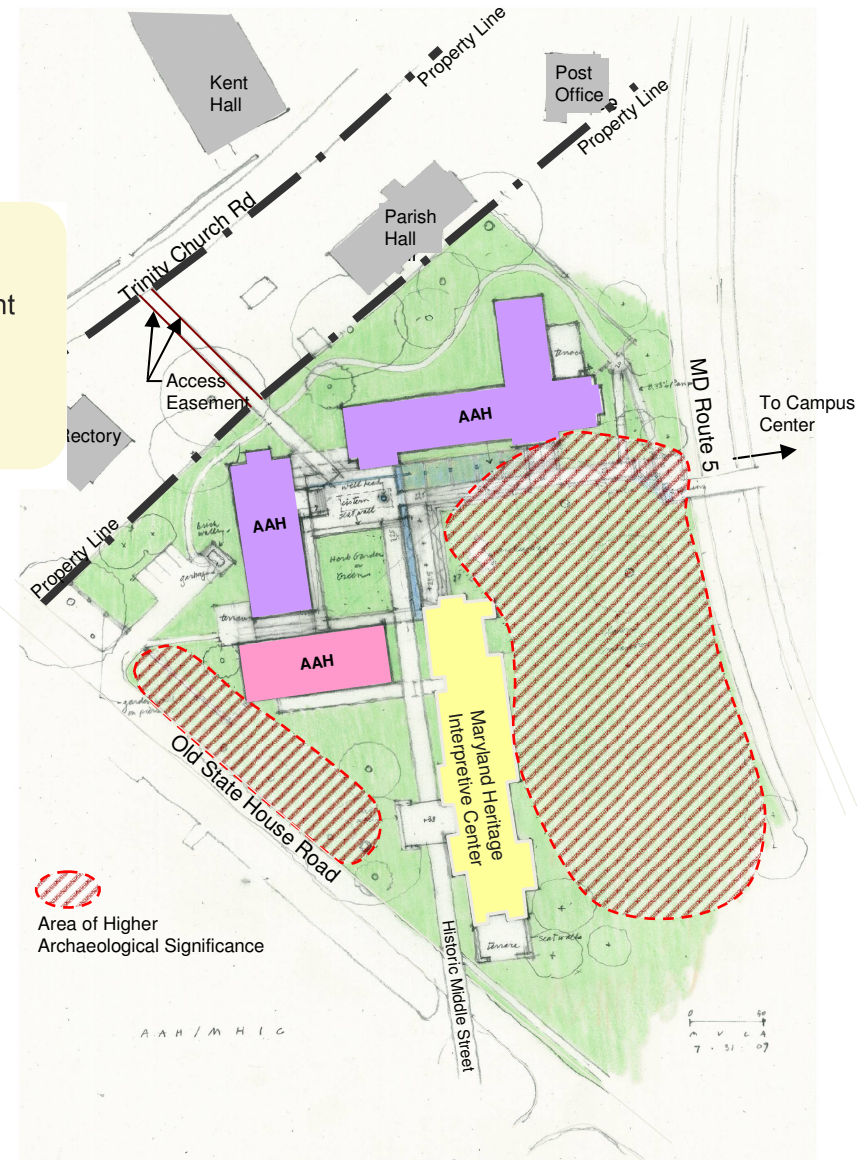

Conceptual Floor Plan Layout

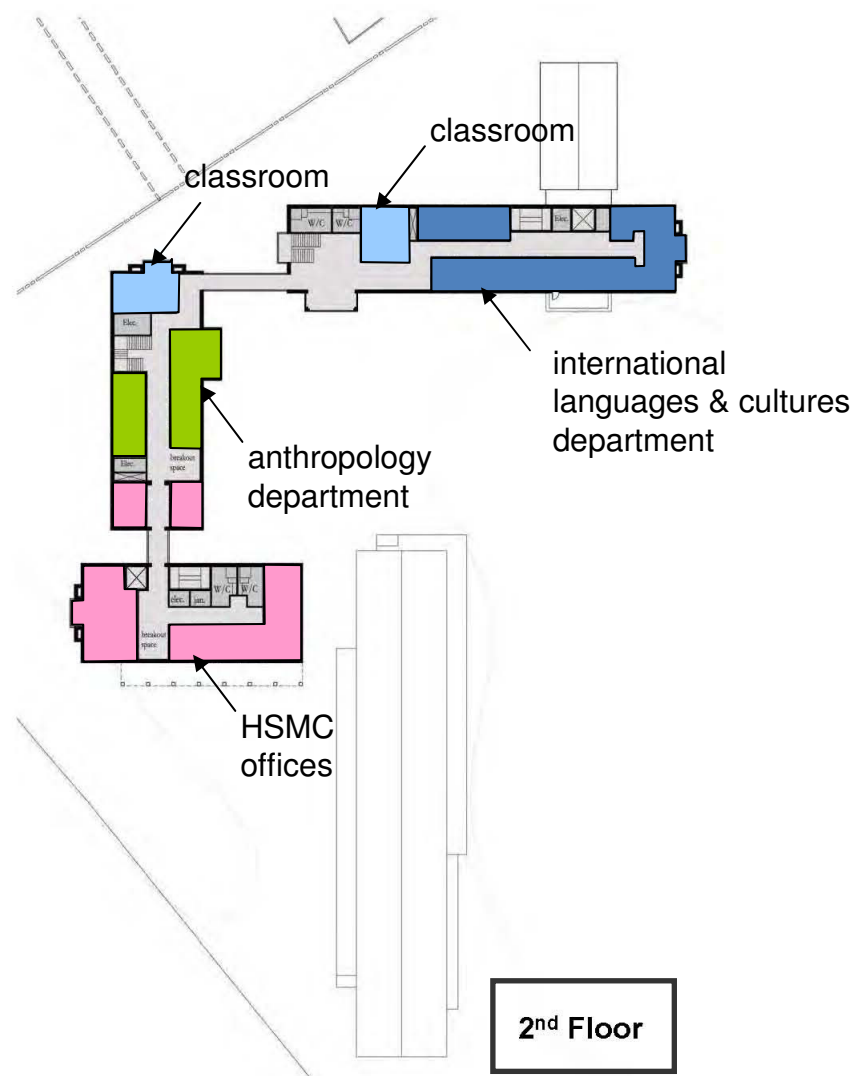
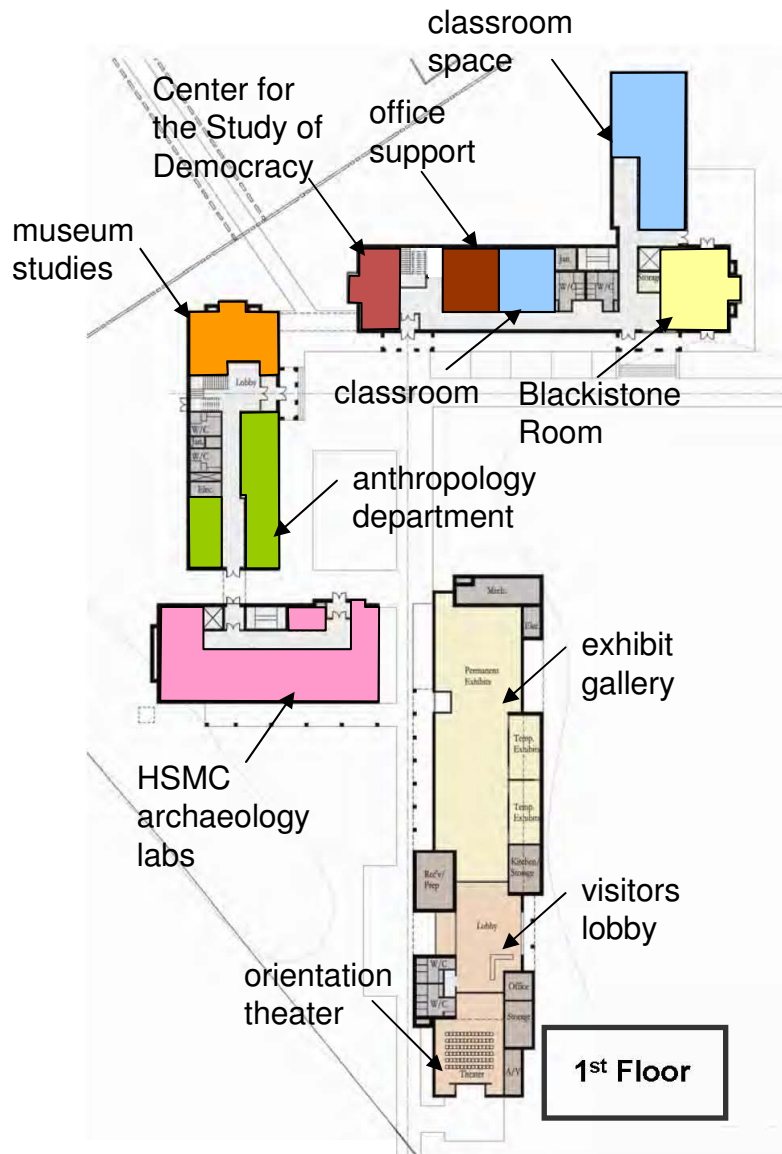

Bird's eye view from the Campus Center

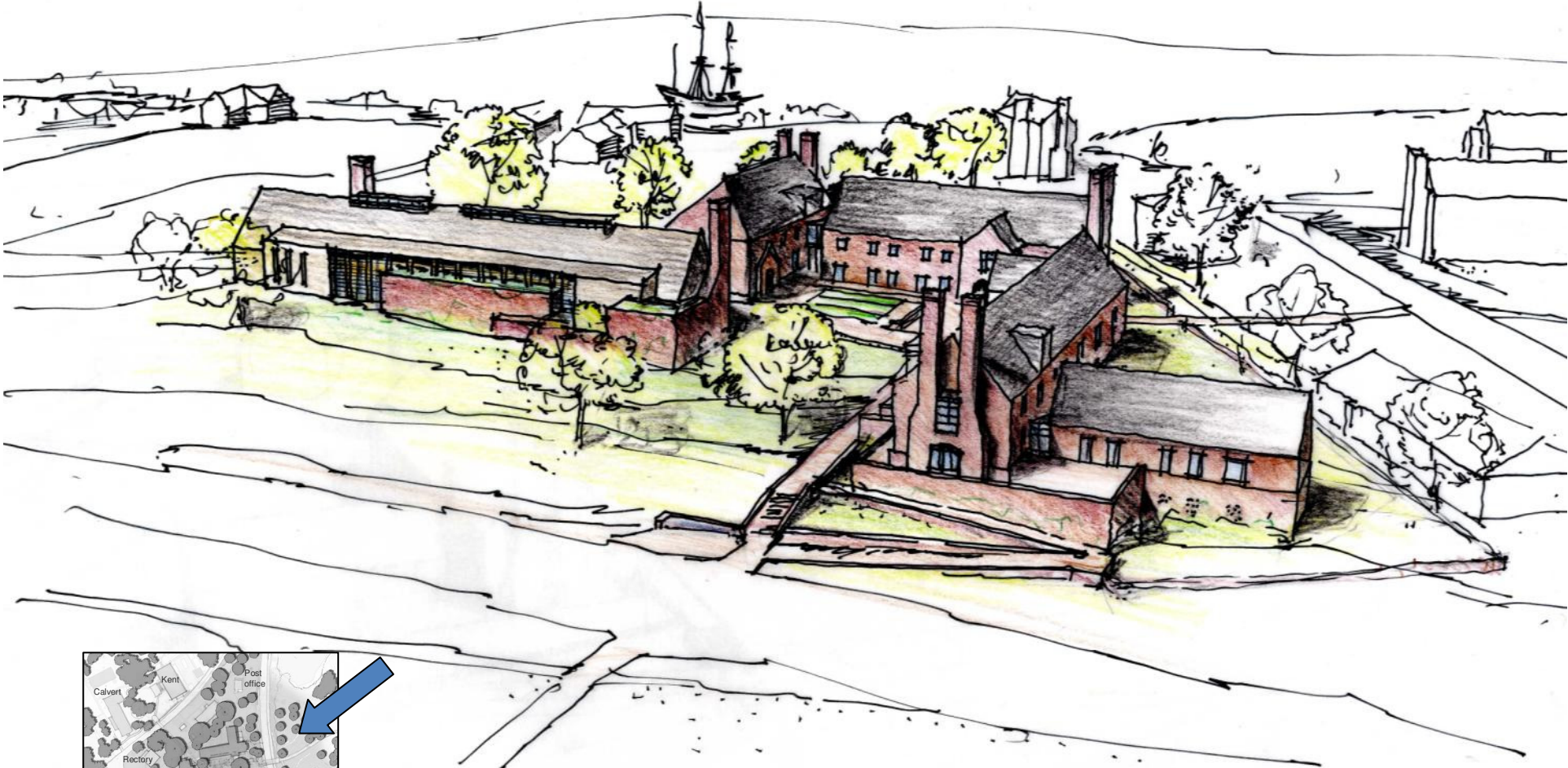

AERIAL VIEW FROM EAST
SEPT. 3, 2009

View from Calvert/Kent Quad



VIEW FROM CALVERT
KENT QUAD
SEPT. 3, 2009

View from Historic parking lot

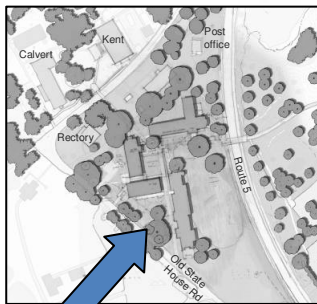

View from Middle Street



SMCM
VIEW FROM SOUTH @
MIDDLE STREET
SEPT. 3, 2009

Anne Arundel Hall Views from the courtyard

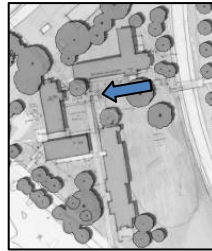
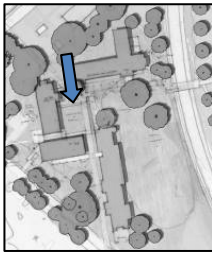
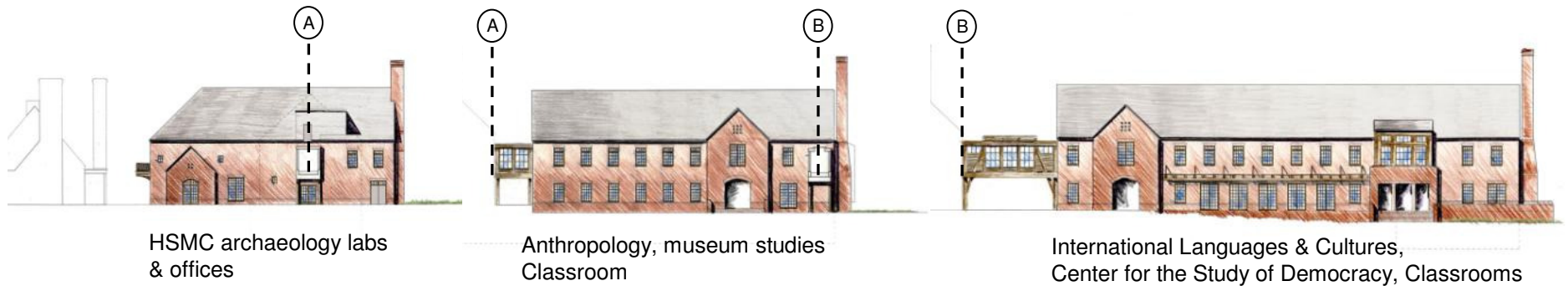

Project Schedule:

Design Phase:

Winter 2009 – Fall 2011

Construction Phase:

Summer 2012 – Winter 2015

Thank you!

The Capital Design Advisory Committee
appreciates your attendance

Please join us for our next Public Information Meeting
on **Thursday September 24th at 7 pm**

To learn more about the project or **send us comments**, go to:

www.smcm.edu/cda