

***CAPITAL DESIGN ADVISORY MEETING***

# Welcome

Anne Arundel Hall Replacement  
Maryland Heritage Interpretive Center

- Program & Site Concepts –  
August 19, 2009

# College and City Affiliation

1839 St. Mary's Female Seminary is established as a **Living Monument** of the historic city by an act of legislature. From its inception, the College has maintained its public mission and independent governing board.

1927 St. Mary's Female Seminary becomes Maryland's first junior college.

1939 Replica of the State House opens for the tri-centennial celebration.

1964 St. Mary's Junior College becomes St. Mary's College of Maryland, a 4-year baccalaureate institution

1966 Historic St. Mary's City Commission (HSMC) is established by Maryland's General Assembly.

1969 HSMC is established as a National Historic Landmark.

1971  The College and HSMC jointly establish the summer Archaeological Field School.

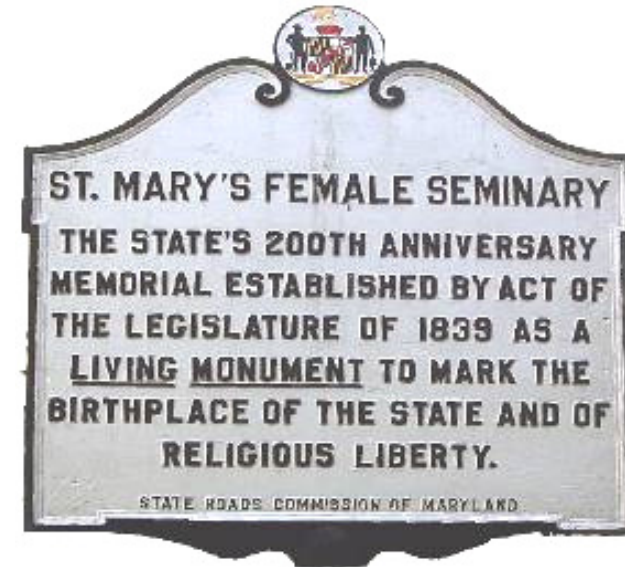



# College and City Affiliation

1992 The College is designated as "The State's Honors College"

1997  Senate Bill 393 creates a formal affiliation between the College and HSMC.

2000  Joint planning of the St. John's Site Museum on campus begins.

2002  The Center for the Study of Democracy is founded as a joint initiative of the College and City.

2007  Museum Studies minor is offered as a joint venture between the City and the College.

2009  Martin Sullivan Scholars Program is established for the development of careers in museums, public history, or historical preservation.



# Academic Space Needs

Maintaining a robust academic program in **Historic Campus** is a core objective of the College.

*“Founded on the site of Maryland's first capital, the College stands as a living legacy to the ideals of freedom and inclusiveness.”*

*Mission Statement*



The Historic Campus provides 1/3 of total academic space.

Historic Campus programs predominately relate to the historic legacy of Maryland's first capital

Academic Programs in the Historic Campus have a 21% shortage.

# Academic Space Needs

The College and City seek to promote **collaborations and joint programming** between faculty, City staff, and students.



The **Museum Studies** program, jointly created by the College and City in 2007, has grown to 24 students in its first two years.

The recently established **Martin E. Sullivan Scholars program** will further expand the Museum Studies program.

The Museum Studies program will benefit from **adjacencies to City archaeology labs and the Interpretive Center.**

# The Need for a New Archaeological Laboratory & Curation Facilities

Current HSMC facility **does not meet standards** for archaeology or museum curation.

Renewal of HSMC's **accreditation is contingent** upon the construction of a new state-of-the-art facility.



Curation space in the current facility is **nearly full**  
**Five million artifacts** and growing!

**Insufficient space** for archaeological analysis

**Limited accessibility** of artifacts by scholars and students

Co-locating HSMC archaeological programs with College academic programs is consistent with Senate Bill 393 of 1997 which called for **enhanced joint educational programming**



# The Need for a New Visitors Center



Security and environmental systems are inadequate at the existing Visitors Center to allow HSMC to borrow valuable objects from other museums



The existing structure limits space layout and adversely affects the visitor experience



Limited space in the existing structure is insufficient for mounting a major permanent exhibit

# The Need for a New Visitors Center



The existing structure is not visible from Route 5 making it difficult for some visitors to find



The opportunity to integrate archaeology with the visitor experience requires adjacencies between Anne Arundel Hall and the new Interpretive Center



# Building Programs – College Academic Space

## Anthropology Department

- Offices
- Seminar room
- Anthropology lab
- Student project room

## International Languages & Cultures Department

- Offices
- Seminar room
- Student project room

## Blackistone Room

## General Classrooms

## Museum Studies Program

- Offices
- Exhibit development lab

## Center for the Study of Democracy



# Building Programs – Archaeology Space

Archaeological research  
& processing

Library; record & archive  
storage

Artifact collection &  
curation

Offices



HSMC Rosecroft Facility



Jefferson Patterson Park

# Building Programs – Interpretive Center

Visitors lobby

Video orientation theater

Exhibit galleries

- Permanent exhibit gallery
- Temporary exhibit space



St. John's Exhibit Building

# Co-location of College and City Programs

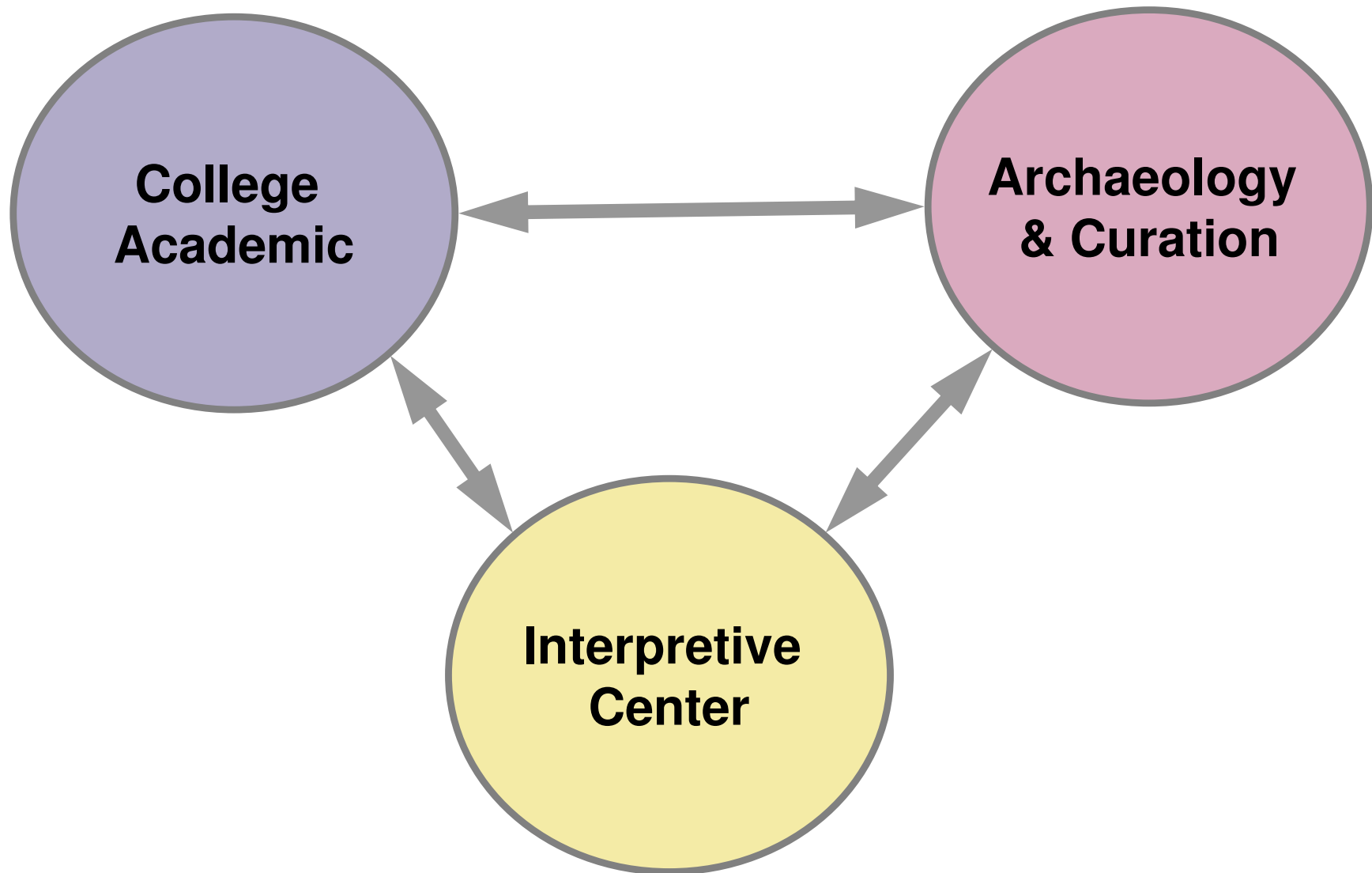

Promotes **joint academic and interpretive programming** as envisioned in the Affiliation Legislative of 1997

# Co-location of College and City Programs

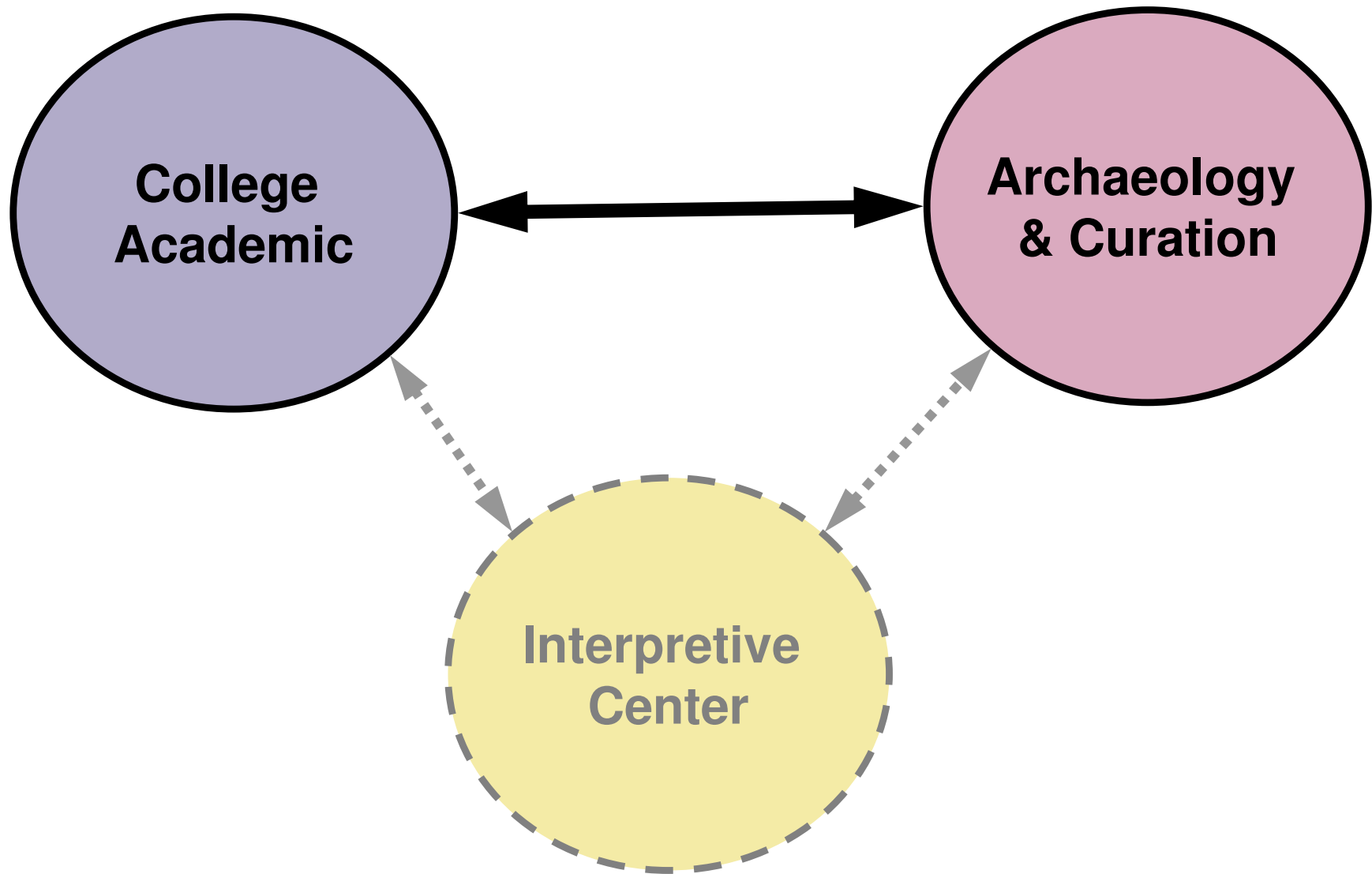

# Co-location of College and City Programs

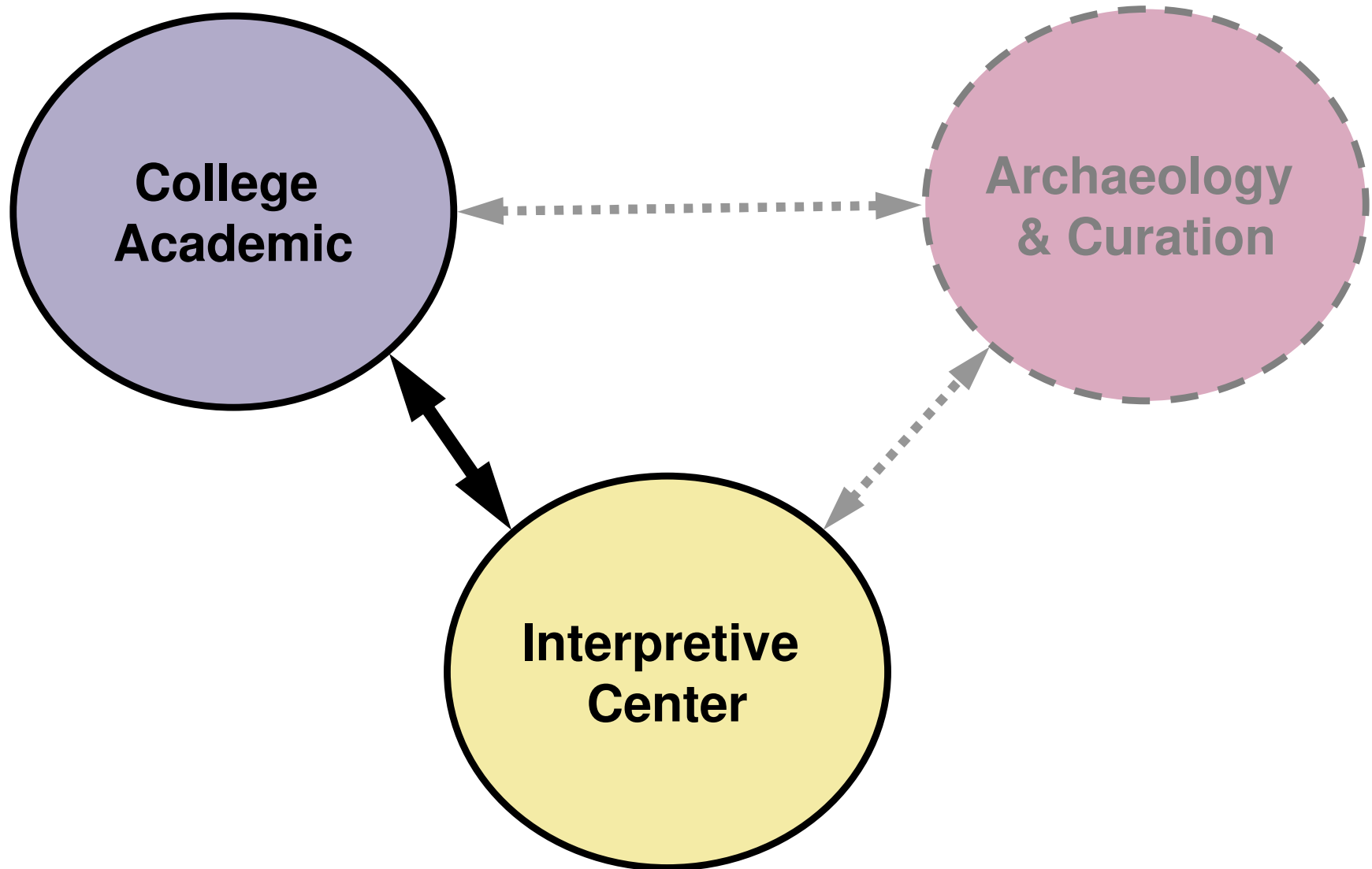

# Co-location of College and City Programs

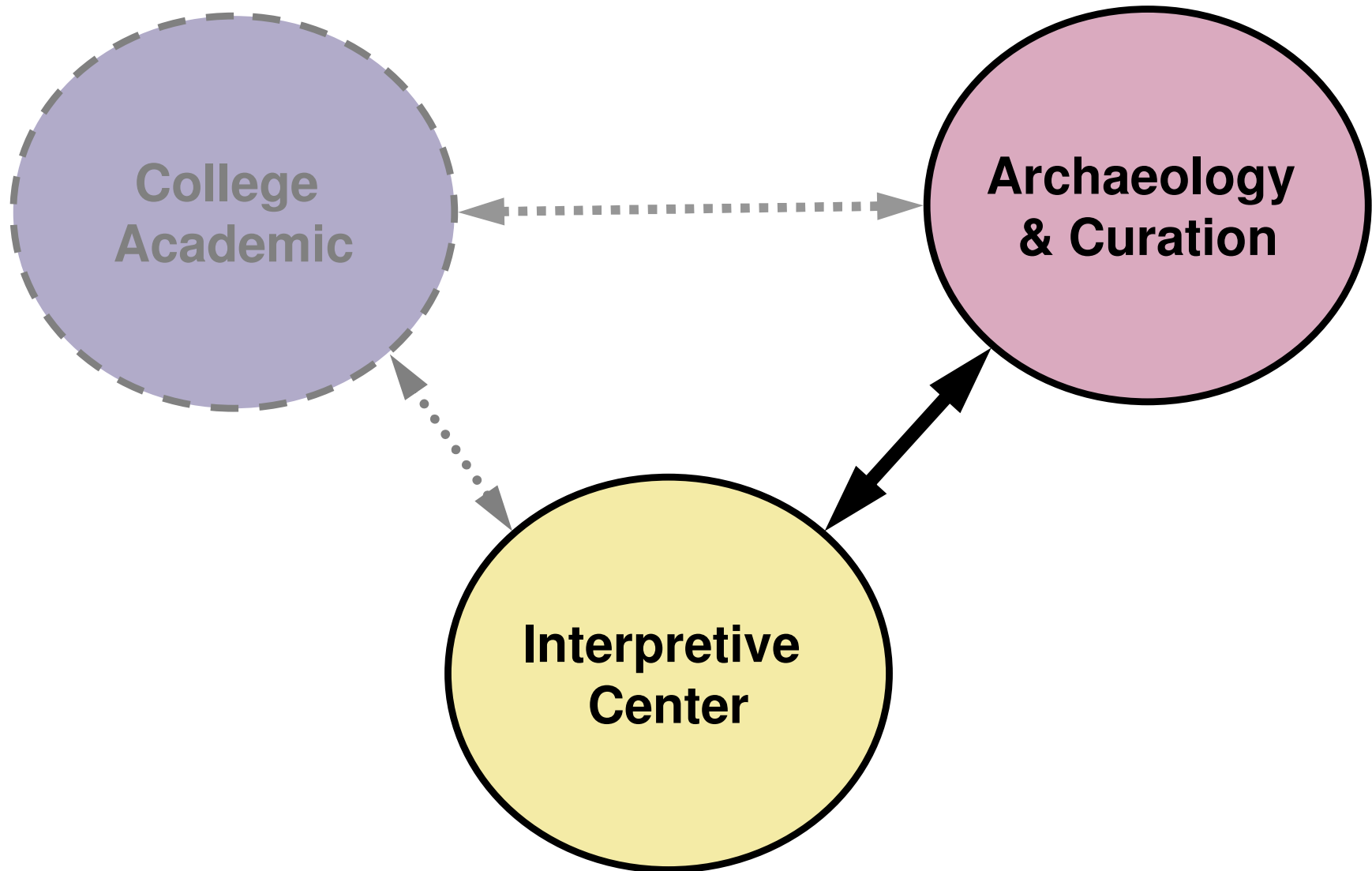

# Site Locations That Were Evaluated

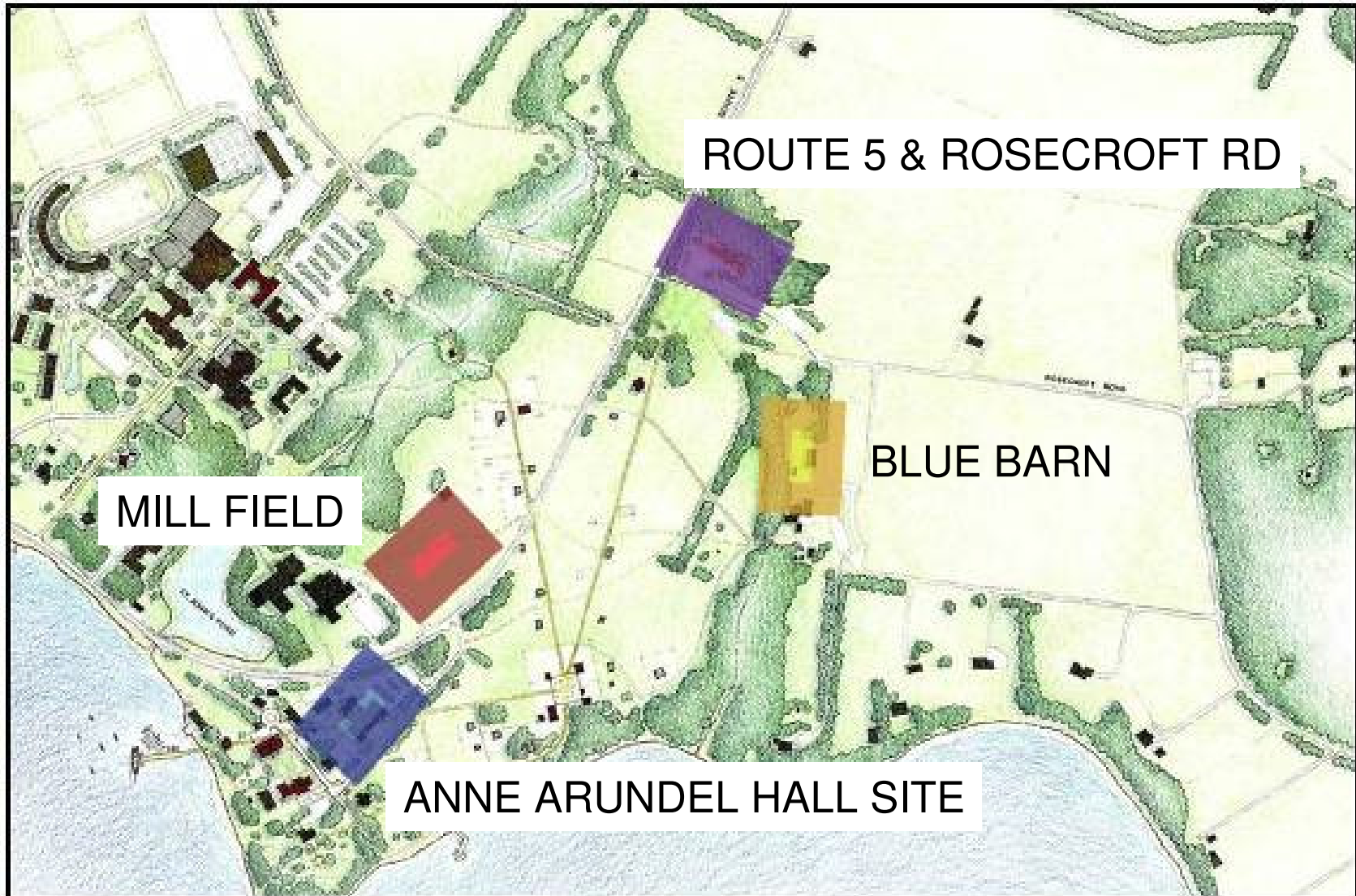





# Site Selection Matrix

CRITERIA	Rosecroft Rd & Route 5	Mill Field	Blue Barn	Anne Arundel Hall Site
<b>A. Programmatic Criteria</b>				
1 Provide convenient student access to City archaeological collections and labs for instruction, research, and employment				
2 Further College mission as a living monument by maintaining an academic presence in the Historic Campus, particularly in subjects related to the legacy of the site				
3 Locate MHIC adjacent to Route 5; at prominent and visible location				
4 Integrate the original City landscape in the visitors' experience				
5 Allow future growth of the MHIC parking as visitation rises				
6 Enhance professional interaction between museum interpretive staff, City archaeology staff, and College faculty				
7 Provide convenient student access to the MHIC temporary exhibit space which will be used as a real life teaching lab for the Museum Studies program				
8 Visibly promote overall goals of the affiliation between the College and City by locating shared facilities and programs at the juncture of the College and the City				
<b>B. General Site Criteria</b>				
1 Avoid/respect areas of high archaeological significance				
2 Protect historic viewshed				
3 Minimize construction on undeveloped sites / improve storm water management on site				
4 Provide adequate, practical, and accessible parking				

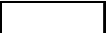
**Key**

-  Does not meet objective
-  Partially meets objective
-  Fully meets objective

# Why not Re-use the Existing Building?

The existing building is unfit for re-use for the following reasons:

## INADEQUACIES:

- Structural capacity (floor loading)
- Exterior walls for environmental control
- Handicap accessibility (3 ground floor levels)



## ENVIRONMENTAL IMPACT:

- 85%-90% of the materials need replacing (floors, windows, exterior walls, interiors)
- All equipment needs replacing (mechanical, electrical, plumbing)
- Cannot be as energy efficient as a new design

# Why not Re-use the Existing Building?

Re-using the existing building would sacrifice the following needs and goals:

## PROGRAMMATIC:

- Designing unique spaces with optimal functionality
- Providing desired space adjacencies



## SITE DEVELOPMENT:

- Incorporating Middle Street
- Avoiding areas of higher archaeological sensitivity
- Reducing the impact on viewshed
- Creating “place”

# Anne Arundel & Margaret Brent Halls in Memoriam



## Anne Arundel & Margaret Brent Halls – in Memoriam

- Document and display images of key architectural elements of Anne Arundel & Margaret Brent Halls
- Commemorate the building's role in the history of the College

# **Archaeological Steps**

- **Phase 1 Reconnaissance Survey**
- **Phase 2 Testing and Evaluation**
- **Phase 3 Full Excavation and  
Data Recovery**











# Maryland State Lands

SHPO Office reviews projects on public lands, determines if there will be adverse impacts to cultural resources, and stipulates measures to avoid or mitigate the damage.

Annotated Code of Maryland  
(Article 83 B, Sections 5-617 and 618)









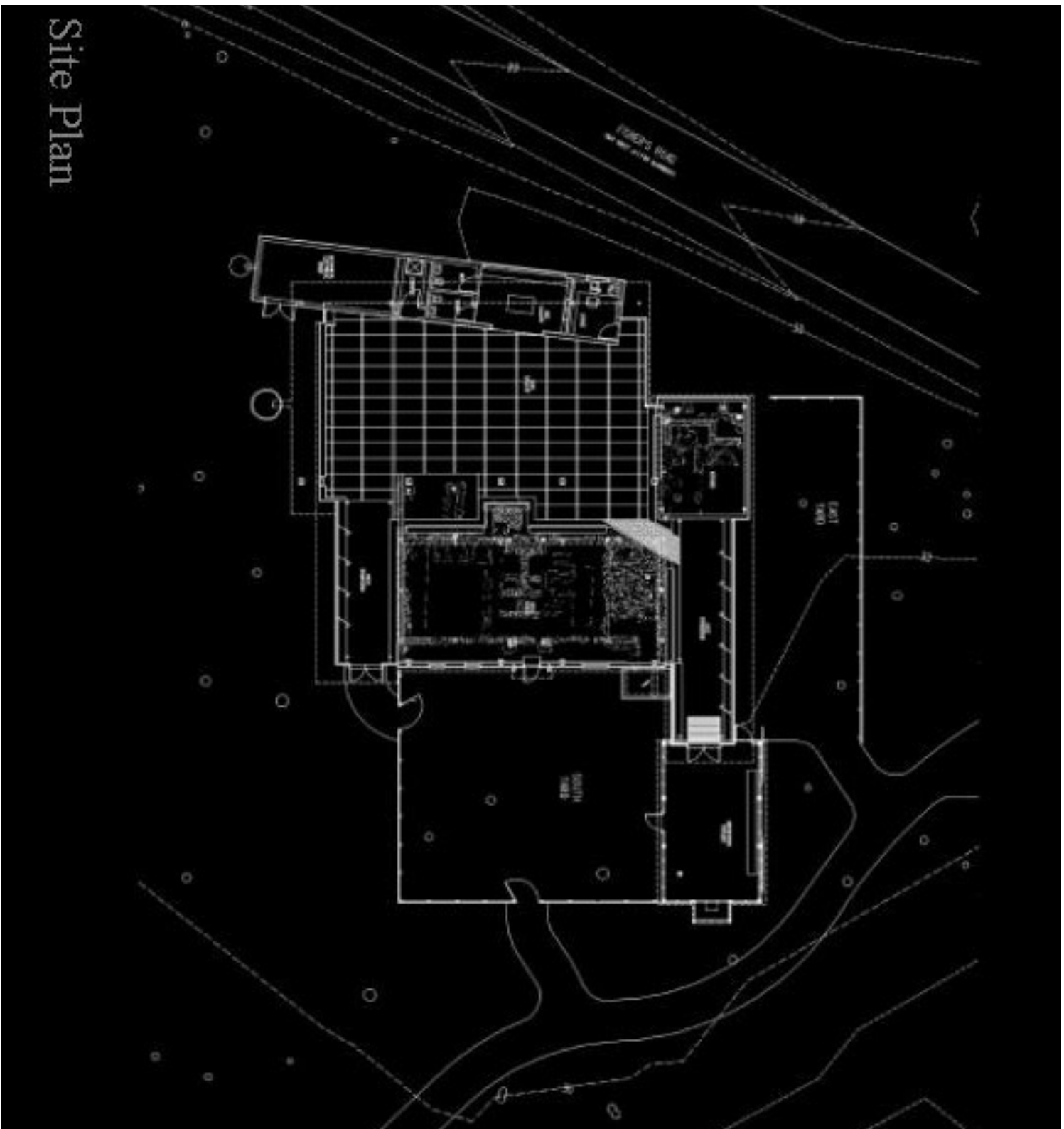

Site Plan

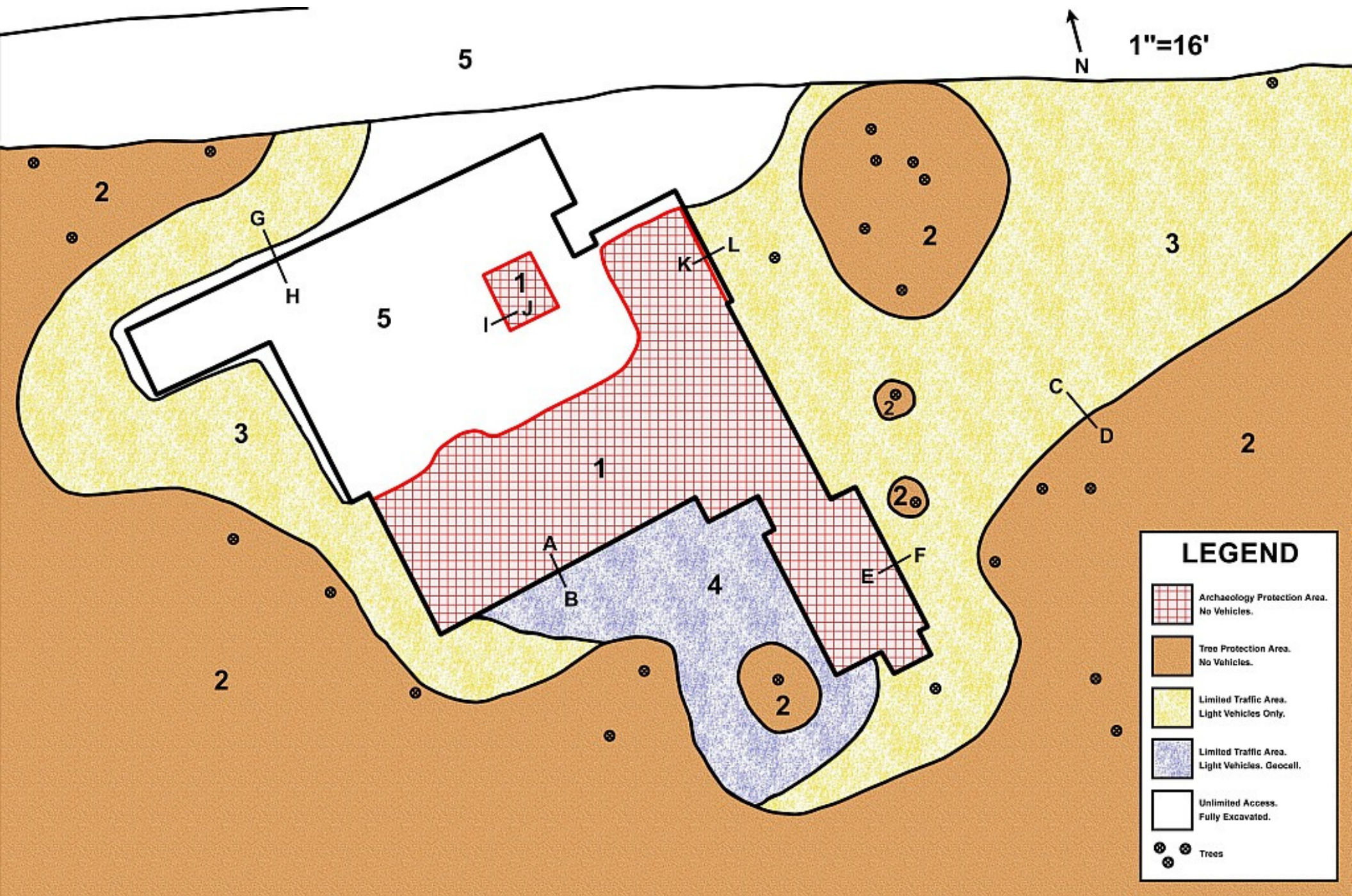

### LEGEND

	Archaeology Protection Area. No Vehicles.
	Tree Protection Area. No Vehicles.
	Limited Traffic Area. Light Vehicles Only.
	Limited Traffic Area. Light Vehicles, Geocell.
	Unlimited Access. Fully Excavated.
	Trees





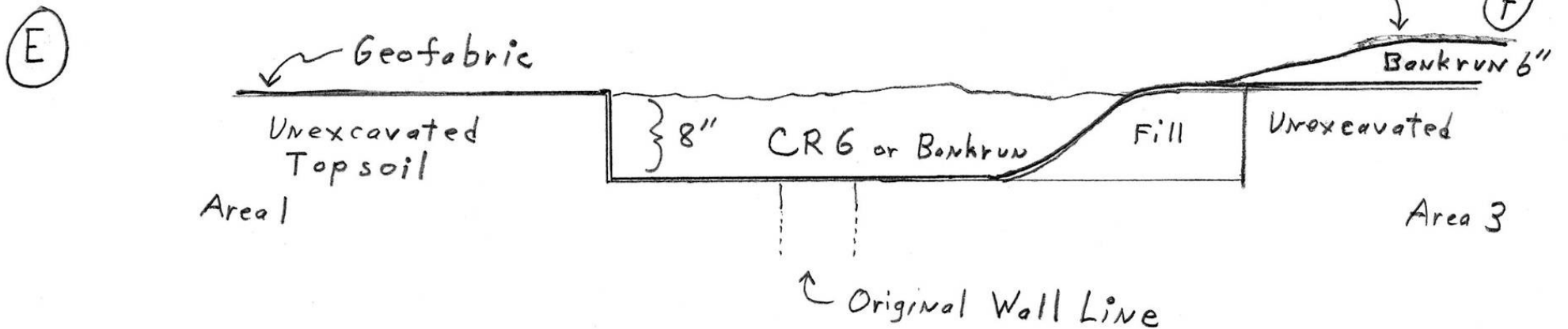
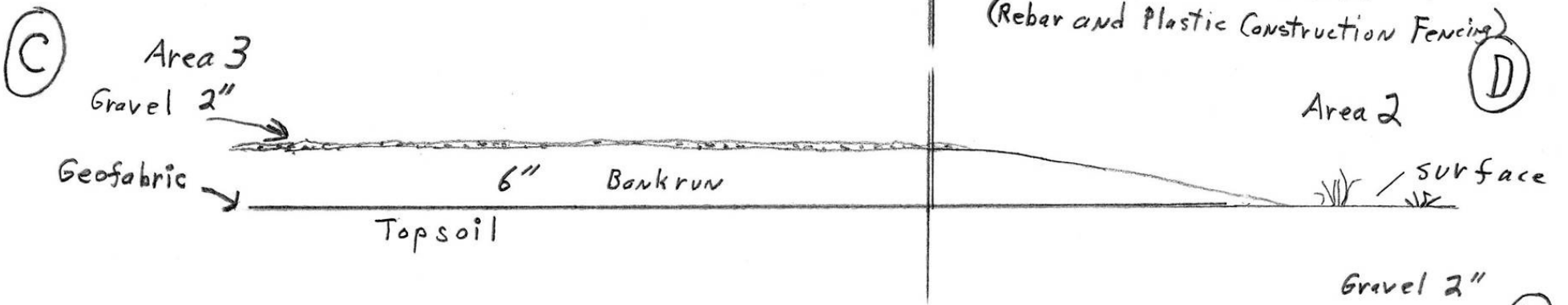
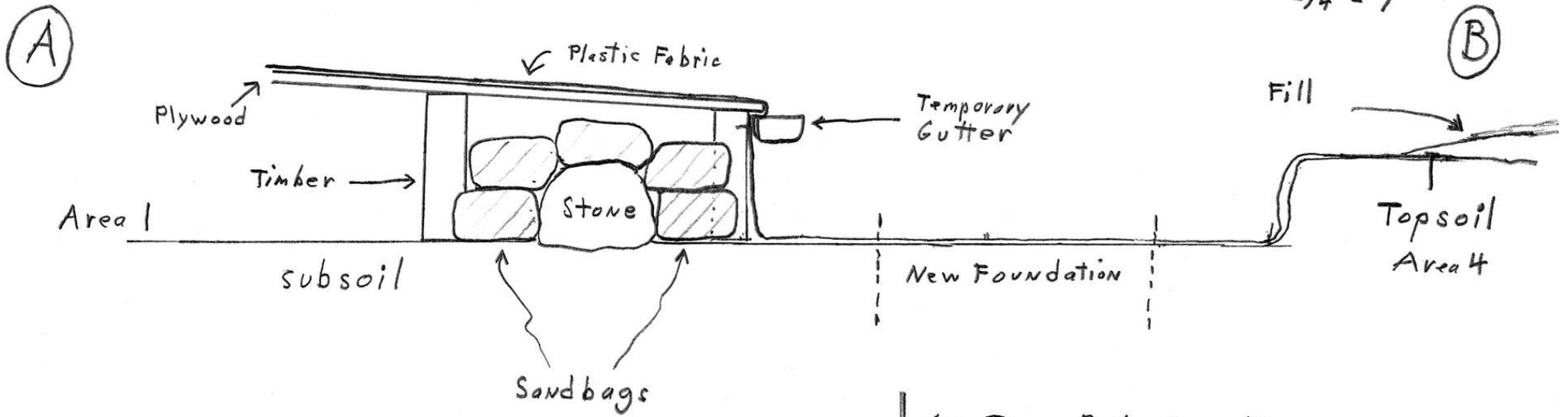









# Anne Arundel Replacement And Maryland Heritage Interpretive Center

- Evidence Evaluation, Synthesis
- Schematic Design
- Develop Mitigation Plan
- SHPO Review and Assessment
- MOU With MD. Historical Trust
- Site Avoidance and/or Mitigation

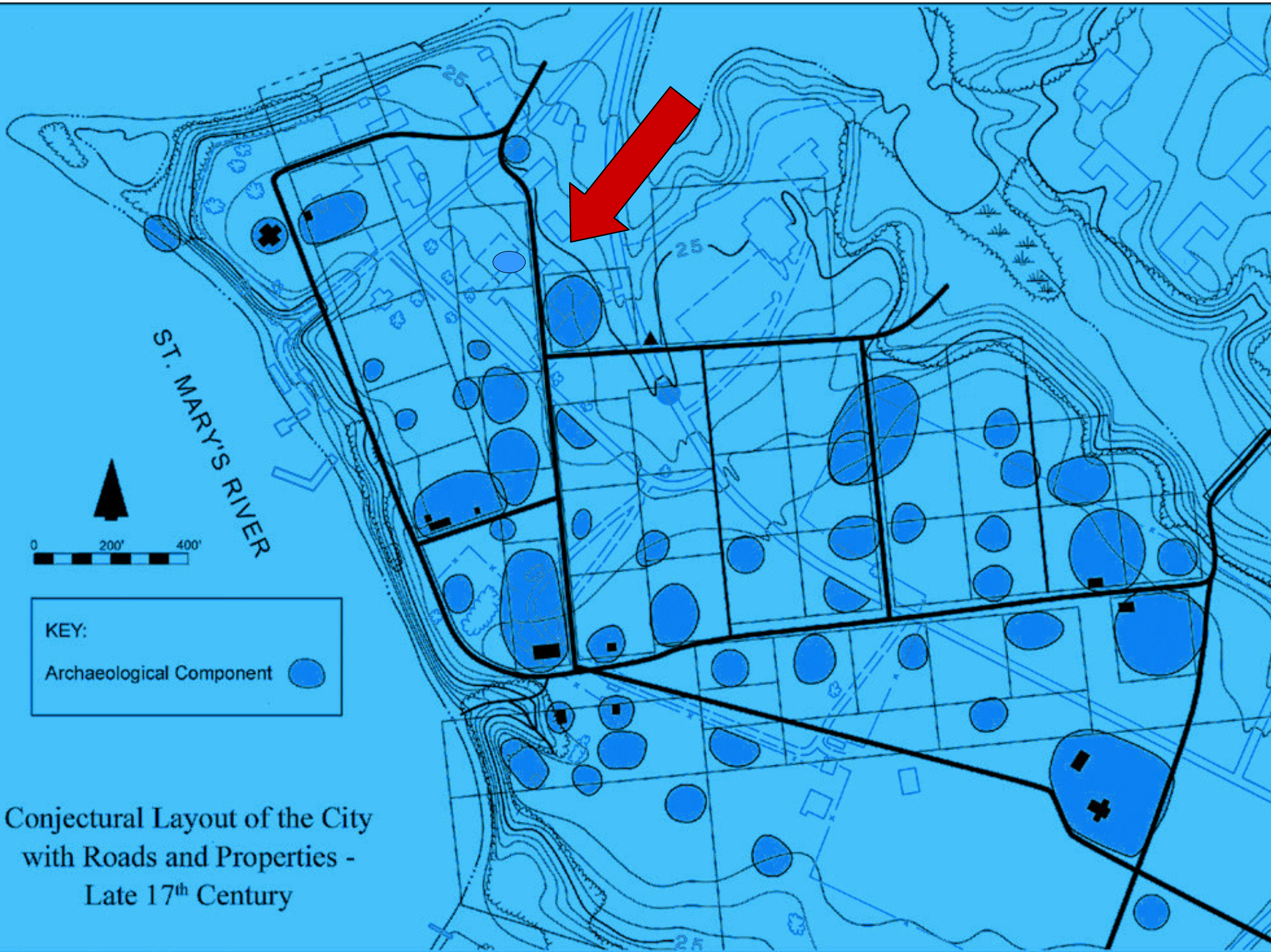



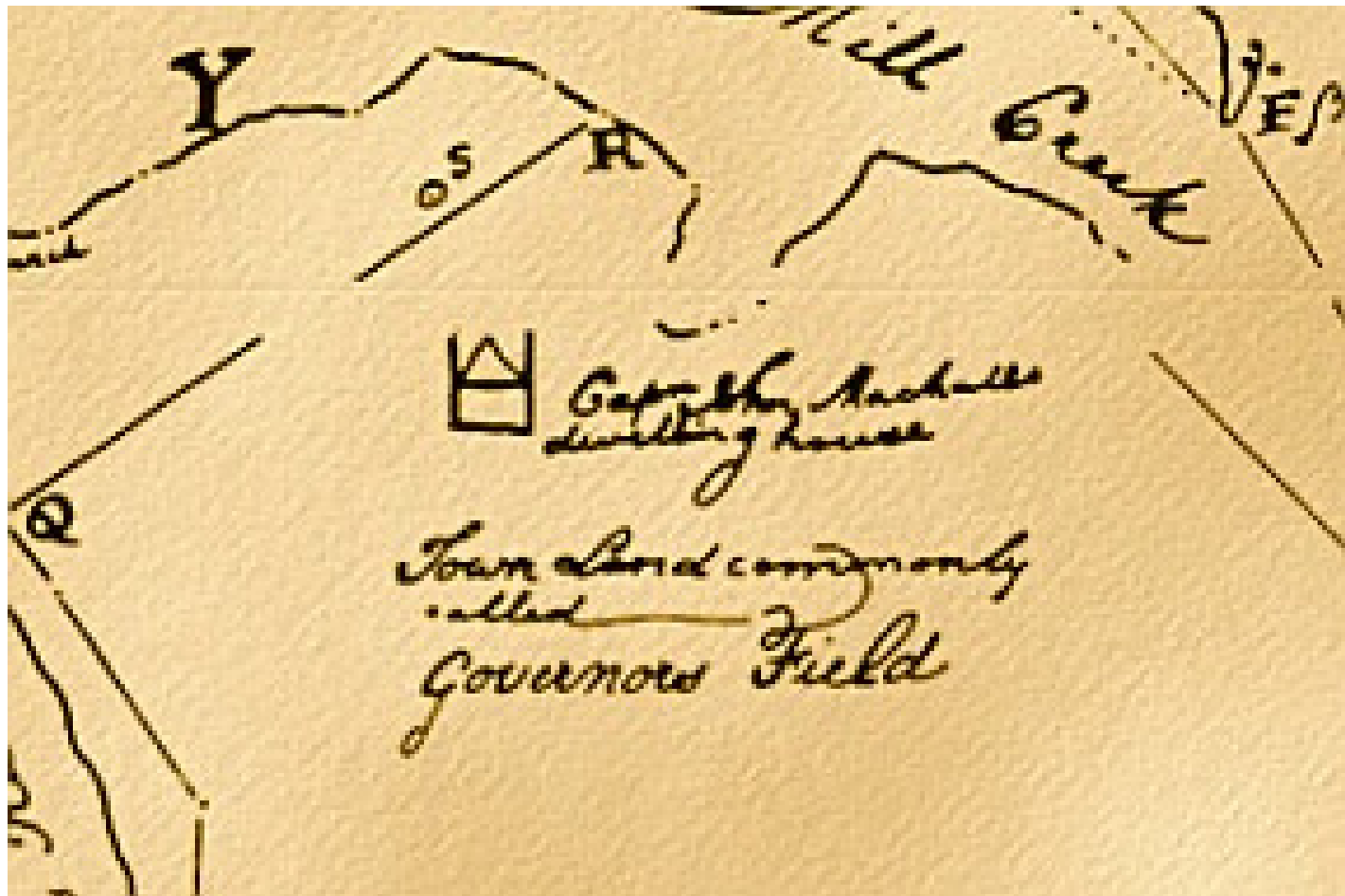



# Archaeological Resources At Anne Arundel

- Prehistoric: Various Times, esp. ca. 200 A.D. – ca. 1634 A.D.
- Colonial: 1640s-1650s??
- Providence Inn: 1675 to ca. 1700
- Hicks Plantation: 1750 to 1774
- Mackall Plantation: 1774 - ca. 1820



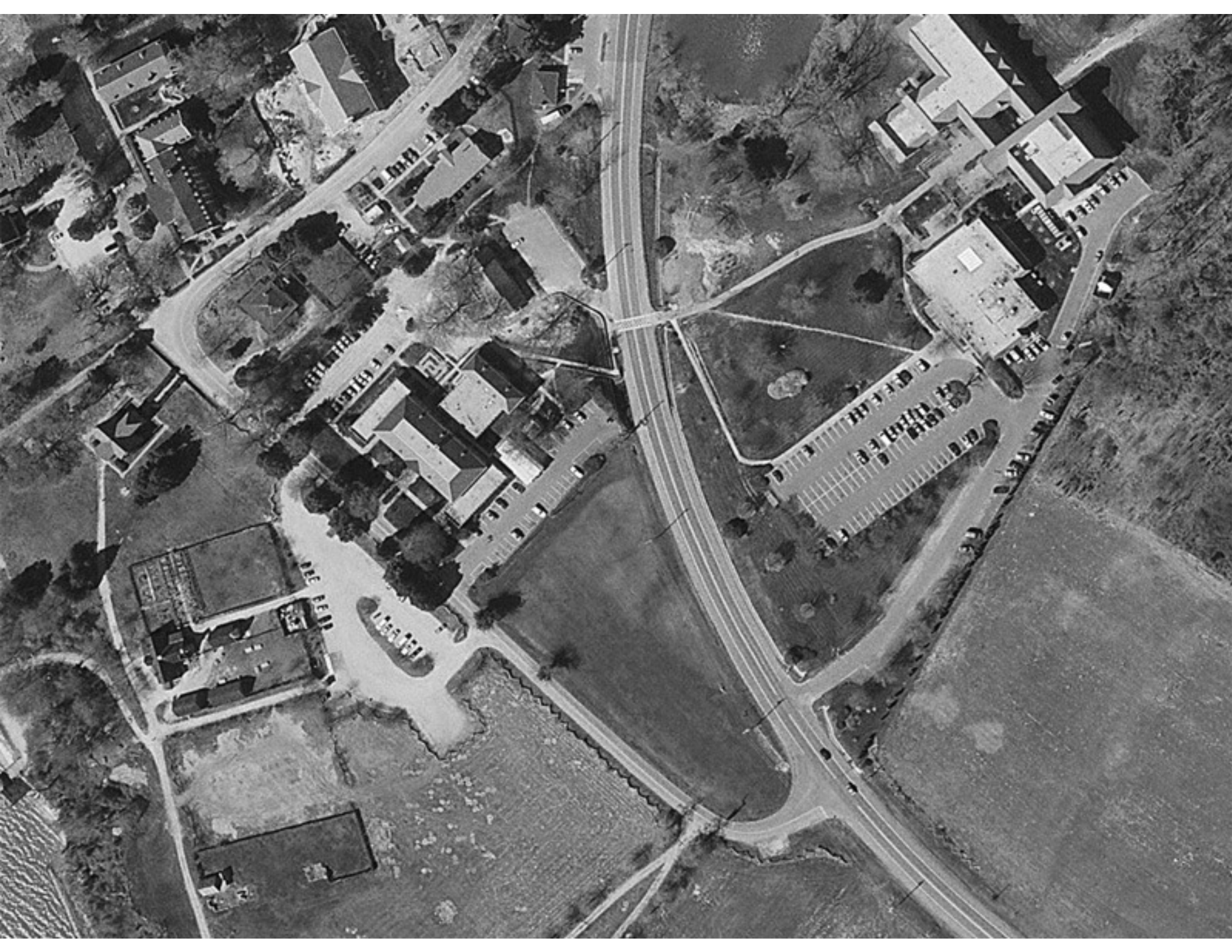





# ARCHAEOLOGICAL SENSITIVITY ZONES



-  LOW SENSITIVITY
-  MEDIUM SENSITIVITY
-  HIGH SENSITIVITY (AVOID)

HSMC  
JUNE 2009  
SHEET 1/2

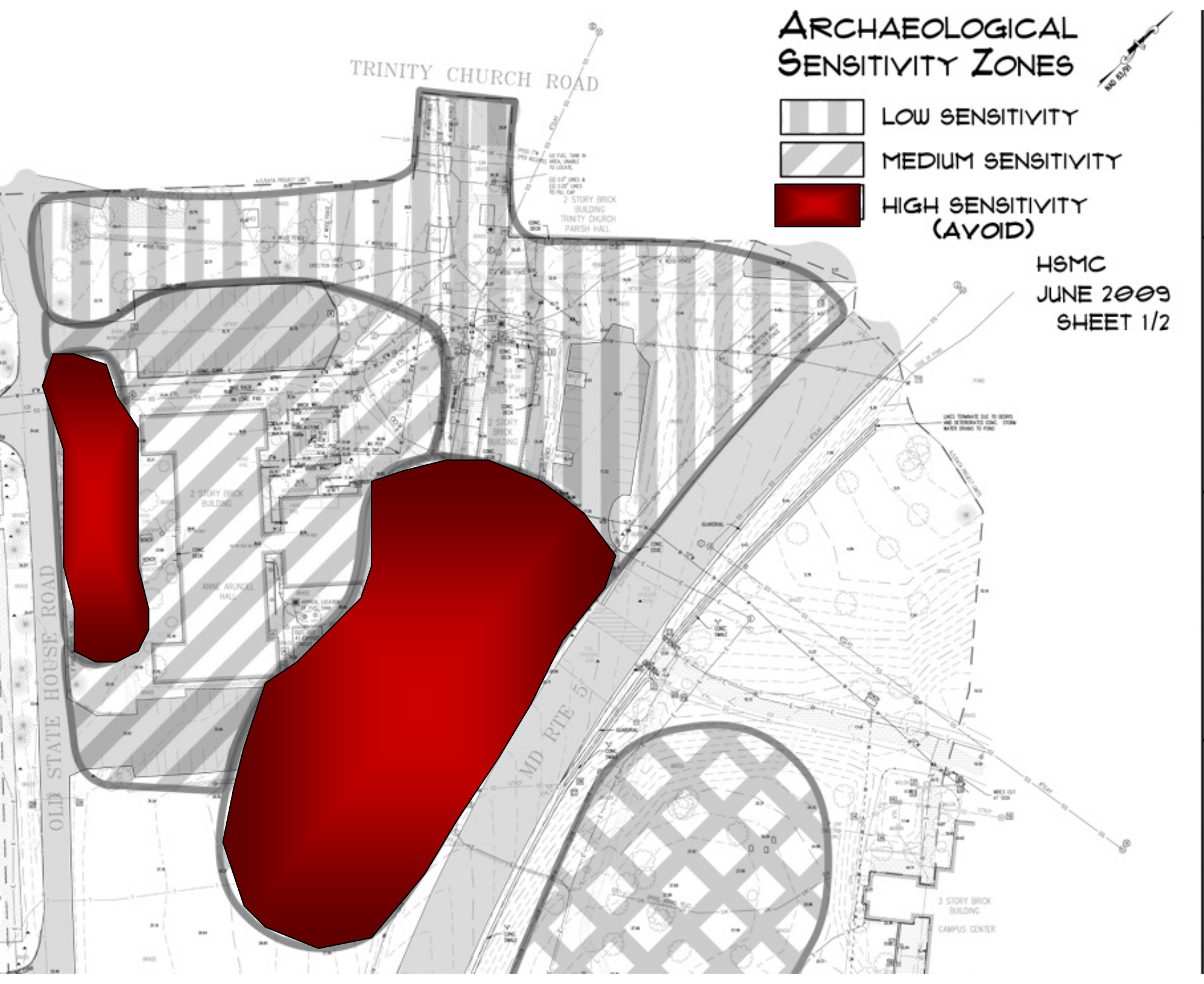

**A/I/DATA**  
 Accurate Infrastructure Data, I  
 1100 Belavia Farm Road, Suite 200, Baltimore, MD 21  
 Phone: 410-666-5091 Fax: 410-666-5093  
 UNDERGROUND UTILITY LOCATING, SURVEYED

SCALE: 1" = 30'  

FIELD WORK FROM:  
 03/16/09 - 04/09/09  
 DRAWN BY: TAZ CHECKED BY: REA  
 DRAWING DATE: 04/13/09  
 FILE NAME:

SUBSURFACE UTILITY DESIGNATING  
 TOPOGRAPHIC WORKSHEET OF PORTION OF  
 ST. MARY'S COLLEGE OF MARYLAND  
 ST. MARY'S CITY, ST. MARY'S COUNTY, MARYLAND

# Archaeology for Construction: A Practiced Process



## Jamestown Archaearium

- Project required the removal of 83 graves



## Intercounty Connector Highway

- 3 sites were evaluated
- Over 200,000 artifacts were removed



## St. John's Site

- Excavated the remains of 6 buildings
- 992,000 artifacts recovered
- Archaeological foundation preserved



# Archaeology for Construction: A Practiced Process

In accordance with State and Federal requirements:

Step 1- Survey the site, identify archaeology and its significance

Step 2 - Develop building plans that preserve/avoid archaeology to the extent possible

Step 3 - If not possible, develop an archaeological mitigation plan to be **approved and permitted by the Maryland State Historical Trust**

Step 4- Complete the excavations, then begin construction

Anne Arundel/MHIC project will:

- Follow **the same process**
- Salvage evidence disturbed in 1950s
- Leave about 90% of archaeology undisturbed

# Site Plan Goals

## SITE DEVELOPMENT OBJECTIVES

- Create a place: a central courtyard
- Connect to Calvert/Kent Quad
- Provide a handicapped accessible path from Route 5 crosswalk
- Respect/Recognize Middle Street
- Create views to State House
- Manage building scale
- No primary building entrance from Route 5
- Preserve or relocate the herb garden

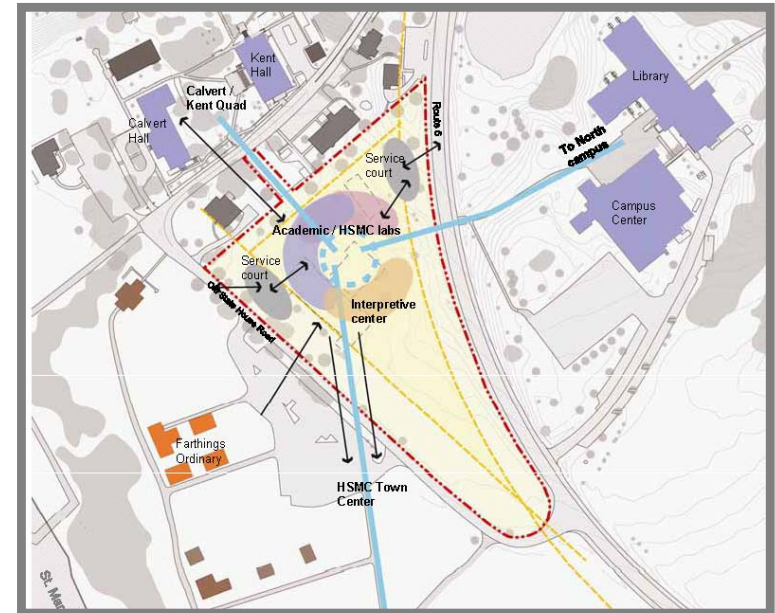

# Site Plan Goals

## STEWARDSHIP GOALS

- Avoid/respect areas of high archaeological significance
- Protect/enhance existing environmental resources
  - Improve storm water management
  - Develop historic spring as a feature
  - Preserve existing trees where possible
- Preserve historic viewshed



# Site Plan Development

The design team developed and evaluated a large number of site plan concepts.

1<sup>st</sup> iteration:

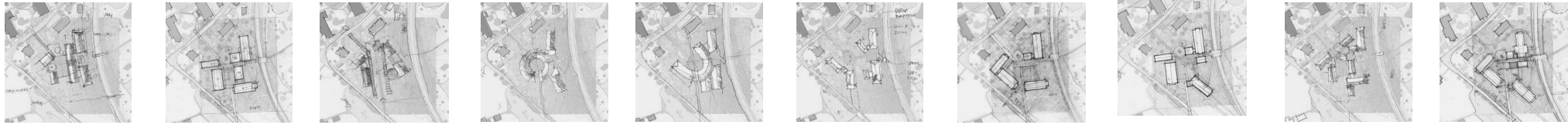

2<sup>nd</sup> iteration:

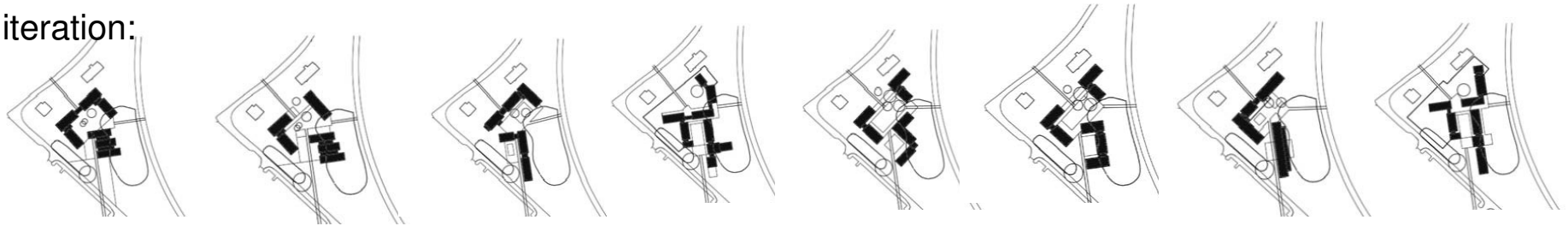

3<sup>rd</sup> iteration:

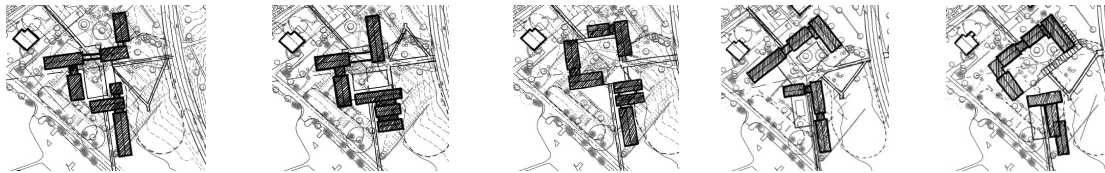

4<sup>th</sup> iteration:



# Proposed Site Plan

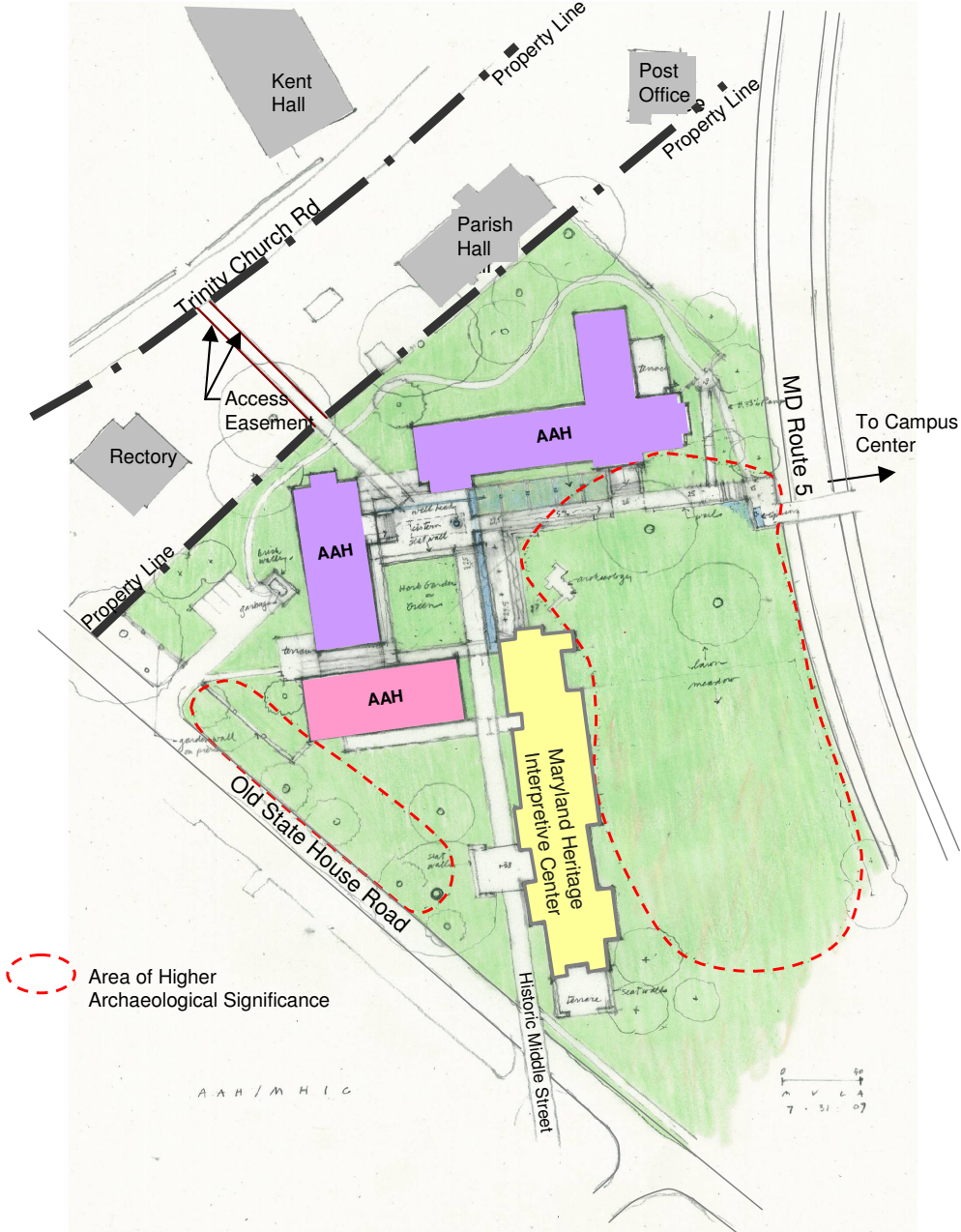

# Proposed Site Plan

Anne Arundel Hall  
Replacement & Maryland  
Heritage Interpretive  
Center

Proposed Mill  
Field Parking

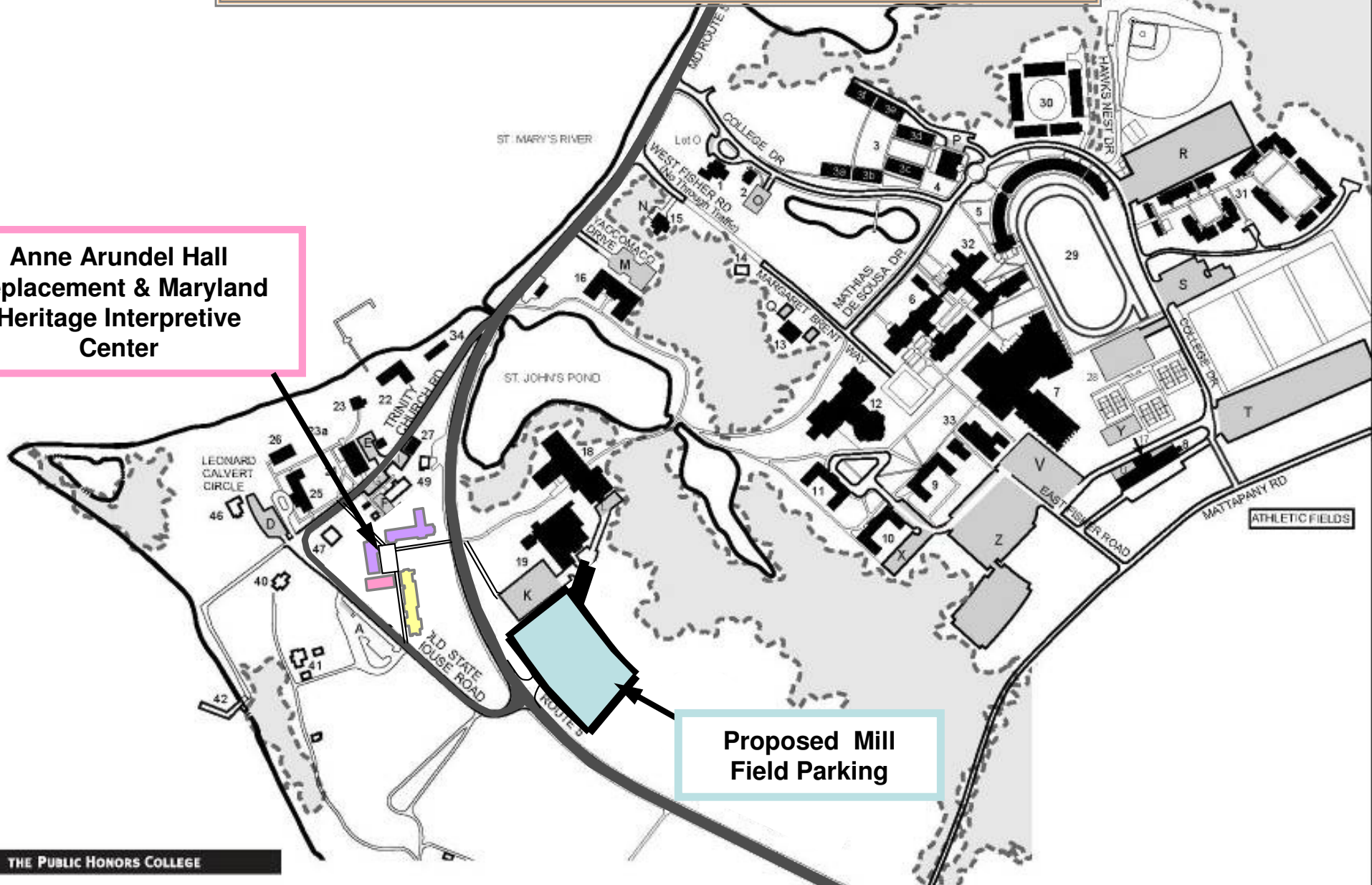

THE PUBLIC HONORS COLLEGE

St. Mary's College of Maryland  
at Historic St. Mary's City

# Proposed Site Plan



# THANK YOU!

**We value your feedback.**

Please fill out a survey  
Here or online at <http://www.smcm.edu/cda>