

St. Mary's College & Historic St. Mary's City



A Collaboration

1839

St. Mary's Female Seminary is established as a **Living Monument** of the historic city by an act of legislature. From its inception, the College has maintained its public mission and independent governing board.



1927

St. Mary's Female Seminary becomes Maryland's first junior college.



1939

Replica of the State House opens for the tri-centennial celebration.

1964

St. Mary's Junior College becomes St. Mary's College of Maryland, a 4-year baccalaureate institution



1966

Historic St. Mary's City Commission (HSMC) is established by Maryland's General Assembly.

1969

HSMC is established as a National Historic Landmark.

1971

The College and HSMC jointly establish the summer Archaeological Field School.

1992

The College is designated as "The State's Honors College"

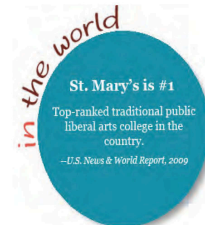

1997

Senate Bill 393 creates a formal affiliation between the College and HSMC.

2000

Joint planning of the St. John's Site Museum on campus begins.



2002

The Center for the Study of Democracy is founded as a joint initiative of the College and City.



2007

Museum Studies minor is offered as a joint venture between the City and the College.

2009

Martin Sullivan Scholars Program is established for the development of careers in museums, public history, or historical preservation.

Academic Space Needs

Maintaining a robust academic program in **Historic Campus** is a core objective of the College.

“Founded on the site of Maryland's first capital, the College stands as a living legacy to the ideals of freedom and inclusiveness.”

Mission Statement

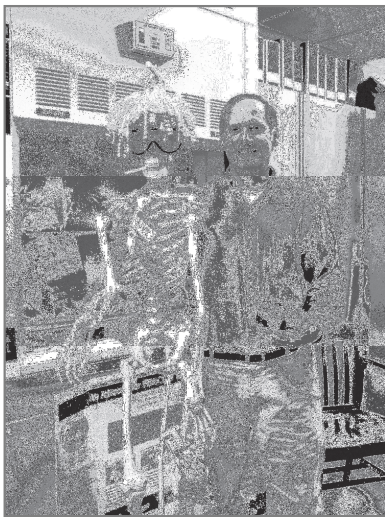

The Historic Campus provides home to **one-third** of the total academic program.

Academic programs within the Historic Campus are predominately **related to the historic legacy** of Maryland's first capital.

According to State guidelines, the College has a 10% shortage in academic space. **Academic Programs in the Historic Campus have a 21% shortage.**

The College and City seek to promote **collaborations and joint programming** between faculty, City staff, and students.



The **Museum Studies** program, jointly created by the College and City in 2007, has grown to 24 students in its first two years.

The recently established Martin E. Sullivan Scholars program will further expand the Museum Studies program.

The program will benefit from adjacencies to City archaeology labs and the Interpretive Center.

The Need for a New Archaeological Laboratory & Curation Facility

The current HSMC facility on Rosecroft Road does not meet the professional standards for archaeology or museum curation as outlined by the American Associations of Museums (AAM). The renewal of Historic St. Mary's City AAM accreditation is **contingent** upon the construction of a new state-of-the-art facility.



The curation space in the current facility is **almost totally filled**. Four decades of excavation have produced a collection of nearly five million artifacts. The current storage spaces (one is in a trailer) cannot be realistically upgraded. The current storage environment **limits accessibility of artifacts** by scholars from other research programs.

Due to overcrowding there is currently **insufficient space** for archaeological analysis.



Student projects and lab tours have to be limited due to **inadequate space and security**.

In accordance with Senate Bill 393 of 1997, HSMC endeavors to expand **opportunities for joint academic programming** with the College by co-locating archaeological research with College programs.



The Need for a New Visitors Center



Today's Visitors Center is a renovated barn structure. The construction of this structure makes precise environmental control for artifacts difficult. The security and **environmental systems are inadequate** to allow HSMC to borrow valuable objects from other museums.



The renovated barn structure limits functional layout of exhibit space resulting in a **visitor experience that is less than optimal**.



The renovated barn structure has no room for changing exhibit galleries to regularly provide new offerings to visitors. **There is also insufficient space for mounting a major permanent exhibit.**



The renovated barn structure is **not visible from Route 5**. Many visitors to Historic St. Mary's City visit the State House area and Farthing's Ordinary and never get to the current visitors center.



The opportunity to integrate archaeology curation activity into the visitor experience **requires** the new Interpretive Center **to be adjacent to the new archeology spaces** in Anne Arundel Hall.

Building Programs

College Academic Space



Anthropology Department

Offices
Seminar room & Anthropology lab
Student project room

International Languages & Cultures Department

Offices
Seminar room
Student project room

Museum Studies Program

Offices
Exhibit development lab

Center for the Study of Democracy

Offices

Classrooms

Blackistone Room (Meeting Room)

HSMC Archaeology Space



Archaeological research & processing

Library; record & archive storage

Artifact collection & curation

Offices

Maryland Heritage Interpretive Center



Visitors welcome area & orientation

Visitors lobby

Video orientation theater

Exhibit galleries

Permanent exhibit gallery

Temporary exhibit space

Benefits of Co-locating Academic, Curation, and Interpretation Programs

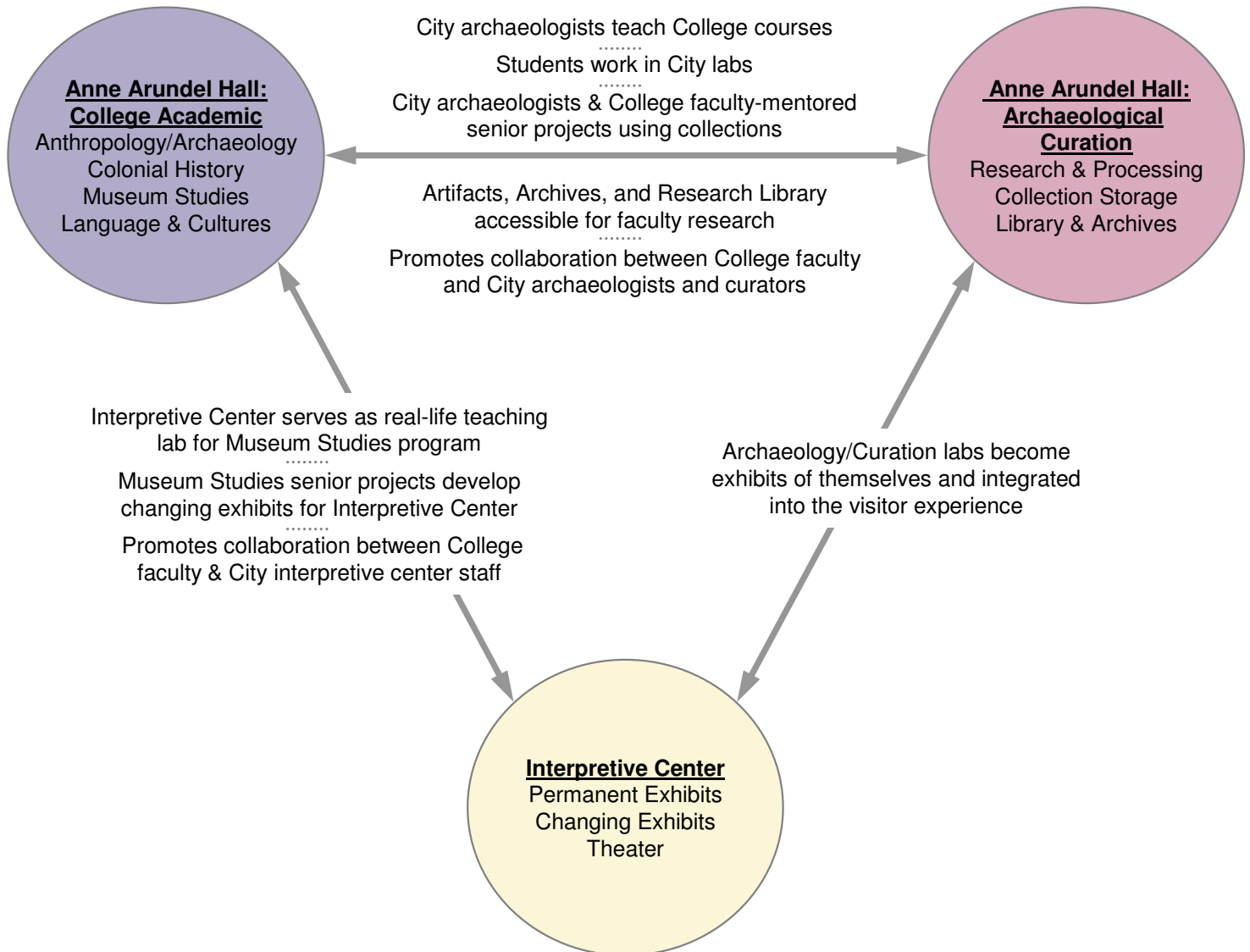

Summary:

Co-locating **College academic programs** related to the legacy of the site with **HSMC's archaeological labs and collection** and the **Maryland Heritage Interpretive Center** will strengthen both institutions service to the State. It will also **promote joint academic and interpretive programming** as envisioned in the 1997 Legislative Affiliation.

Exhibit Goals

Interpretive Center:

- Provide an effective orientation for visitors to the area
- Present the basic story of the history and significance of St. Mary's City
- Create interest to visit the various museum sites within the historic park
- Provide an indoor gallery experience that explores various historical topics of relevance to the area, the Chesapeake region, and early America.



Archaeology & Curation Programs

- Provide exhibit space for three dimensional objects
- Highlight recent archaeological field and curation activities
- Create views into archaeological processing labs to allow visitors to the adjacent Interpretive Center to observe ongoing artifact analysis and preservation activities

Academic Programs

- Highlight student projects & faculty achievements in anthropology, museum studies and language and cultures programs.
- Identify and promote the Center for the Study of Democracy
- Highlight the historical significance of the College



Anne Arundel & Margaret Brent Halls – in Memoriam

- Document and display images of key architectural elements of Anne Arundel & Margaret Brent Halls
- Commemorate the building's role in the history of the College

Site Locations That Were Evaluated

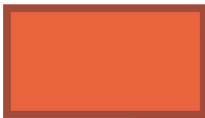
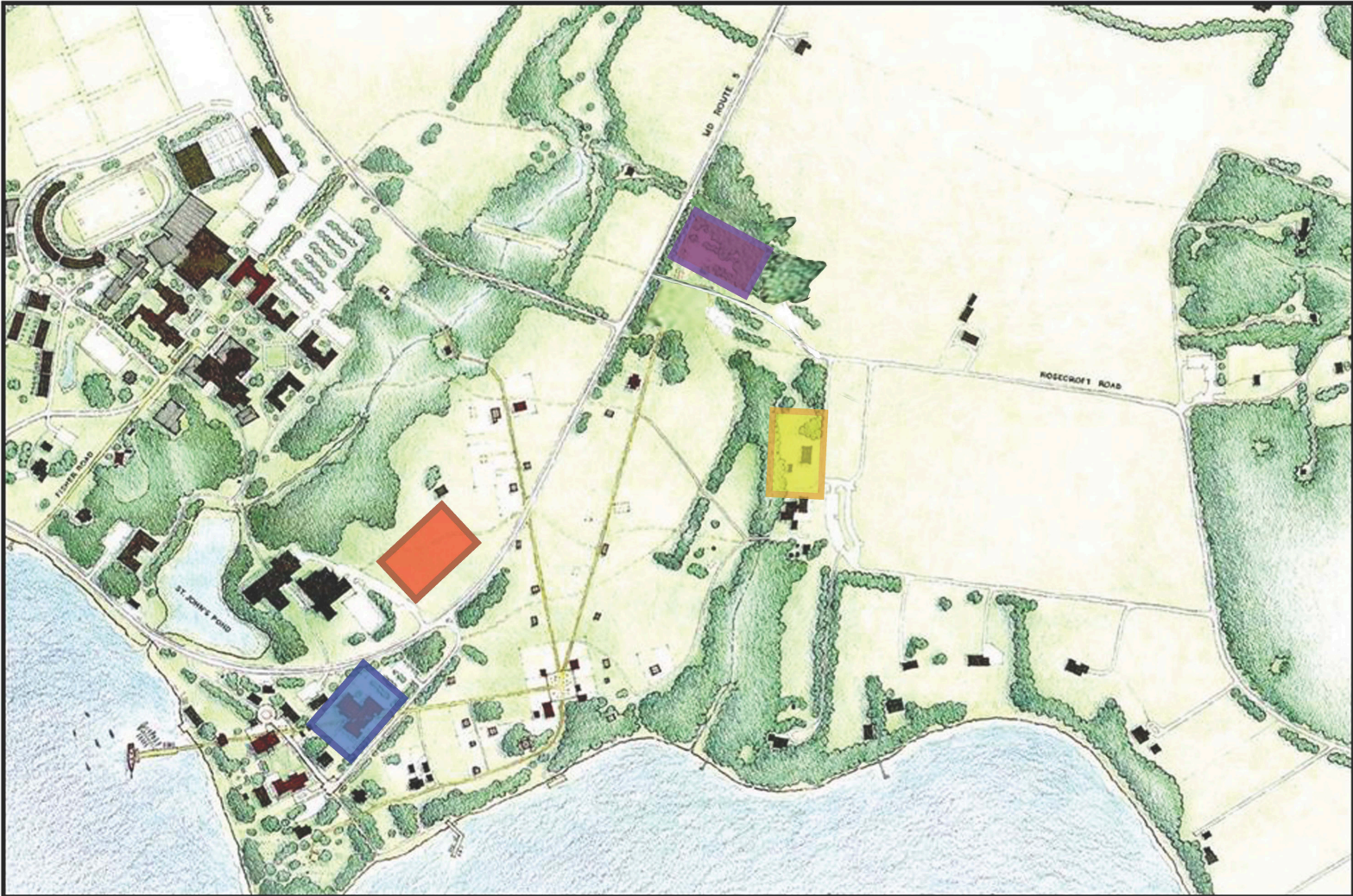

Mill Field



Anne Arundel Hall



Blue Barn



Route 5 and Rosecroft Road

Archaeology for Construction: A Practiced Process

In accordance with State and Federal requirements:

- Step 1- Survey the site, identify archaeology and its significance
- Step 2 - Develop building plans that preserve/avoid archaeology to the extent possible
- Step 3 - If not possible, develop an archaeological mitigation plan to be **approved and permitted by the Maryland State Historic Trust**
- Step 4- Complete the excavations, then begin construction

Similar Projects



Jamestown Archaearium

- Project required the **removal** of 83 graves



Intercounty Connector Highway

- 3 sites were evaluated
- Over **200,000 artifacts removed**



St. John's Site

- Excavated remains of 6 buildings
- **992,000 artifacts recovered**
- Archaeological foundation preserved for exhibit

Anne Arundel/MHIC project will:

- Follow **the same process**
- Salvage evidence disturbed in 1950s
- Leave about 90% of archaeology undisturbed

Why not Re-use the Existing Building?

1- WHY NOT RE-USE THE ENTIRE ANNE ARUNDEL HALL?

PROS

- The re-use of the existing AAH building is estimated to save 11% in construction cost

CONS

- The existing building is in poor condition and doesn't meet current code requirements. Re-using AAH would necessitate extensive structural, mechanical, and plumbing renovations
- The existing building can't accommodate all the programmatic needs
- The re-use of the existing building would not allow the City and the College to make the best use of available land
- The re-use of the existing building would prevent co-locating the Interpretive Center on site



2- WHY NOT RE-USE PORTIONS OF ANNE ARUNDEL HALL?

Site Considerations

PROS

- Preserves the memory of the building
- Minimizes site disturbance

CONS

- Blocks the continuation of historic Middle Street
- Dominates the HSMC landscape
- Pushes Interpretive Center into an area of higher archaeological significance



Sustainable Design Considerations

PROS

- Extends the life cycle of the building

CONS

- Poor energy efficiency of existing structure
- After extensive renovation to address code, structural and mechanical systems, only a small portion of the original embodied energy remains



Program Considerations

PROS

- Academic program fits in existing main wing
- MHIC program fits on first floor of main wing
- Blackstone Room or several classrooms fit in Library wing

CONS

- The existing building does not accommodate all the programmatic needs
- Extensive intervention is required to accommodate new programs and bring up to code
- Existing structure restricts ability to create public spaces and open up entry.
- Not suitable for HSMC lab portion due to loading and environmental requirements
- Not suitable for the configuration and circular flow of public spaces.

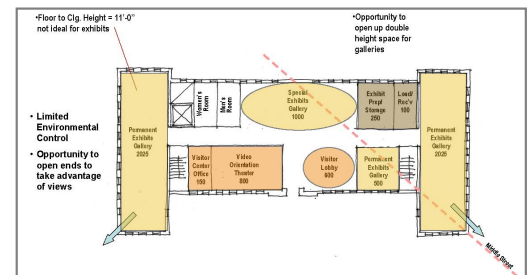

Conclusion:

Based on the challenges of the site planning, sustainability criteria, and programmatic needs, we are proposing to demolish Anne Arundel Hall, and to construct new buildings to house the College academic spaces, City archaeology labs, and the Maryland Heritage Interpretive Center.

Site Selection Matrix

CRITERIA	OPTION A	OPTION B	OPTION C	OPTION D
	Rosecroft Rd & Route 5	Mill Field	Blue Barn	Anne Arundel Hall Site
A. Programmatic Criteria				
1 Provide convenient student access to City archaeological collections and labs for instruction, research, and employment				
2 Further College mission as a living monument by maintaining an academic presence in the Historic Campus, particularly in subjects related to the legacy of the site				
3 Locate MHIC adjacent to Route 5; at prominent and visible location				
4 Integrate the original City landscape in the visitors' experience				
5 Allow future growth of the MHIC parking as visitation rises				
6 Enhance professional interaction between museum interpretive staff, City archaeology staff, and College faculty				
7 Provide convenient student access to the MHIC temporary exhibit space which will be used as a real life teaching lab for the Museum Studies program				
8 Visibly promote overall goals of the affiliation between the College and City by locating shared facilities and programs at the juncture of the College and the City				
B. General Site Criteria				
1 Avoid/respect areas of high archaeological significance				
2 Protect historic viewshed				
3 Minimize construction on undeveloped sites / improve storm water management on site				
4 Provide adequate, practical, and accessible parking				

Key

- Does not meet objective
- Partially meets objective
- Fully meets objective

Site Plan Goals

SITE DEVELOPMENT OBJECTIVES

- Create a place/destination: a central courtyard
- Alignment to Calvert/Kent Quad through an easement in Church property
- Respect/Recognize historic Middle Street
- Create views to State House
- Provide a handicapped accessible path from Route 5 crosswalk to Calvert/Kent Quad through Anne Arundel Hall/MHIC
- Manage building scale
- No primary building entrance from Route 5 – buildings look inward to courtyard
- Preserve or relocate the herb garden

STEWARDSHIP GOALS

- Avoid/respect areas of high archaeological significance
- Protect/enhance existing environmental resources
 - Improve storm water management
 - Develop historic spring as a feature
 - Preserve existing trees where possible
- Preserve historic viewshed

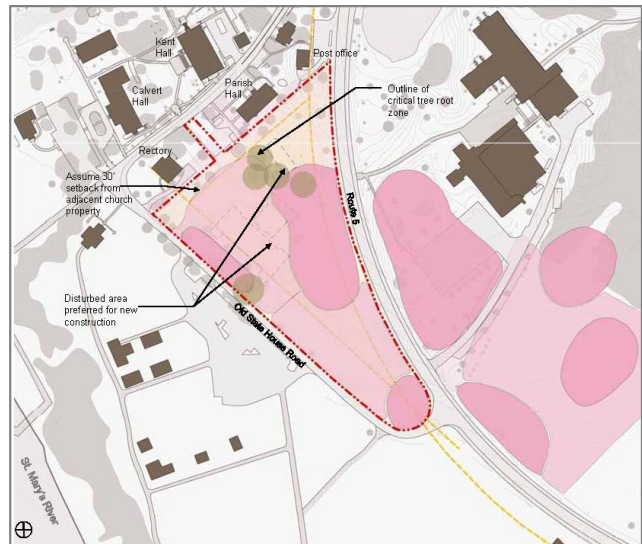
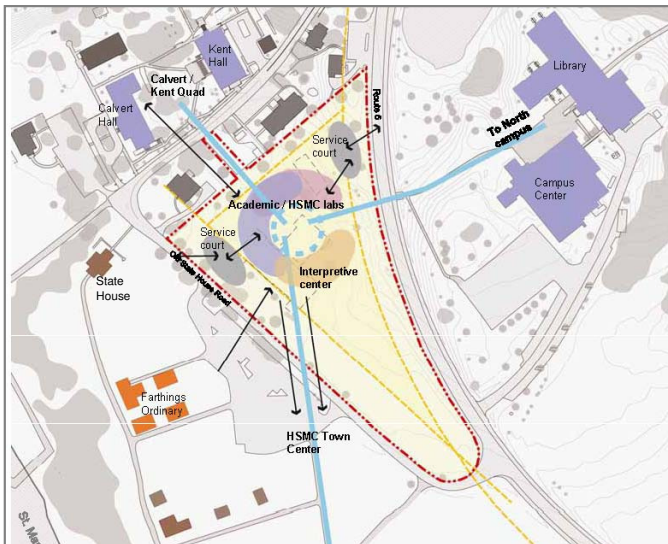

 Area of higher archaeological significance

Site Plan Development

The design team developed and evaluated a large number of site plan concepts.

1st iteration:

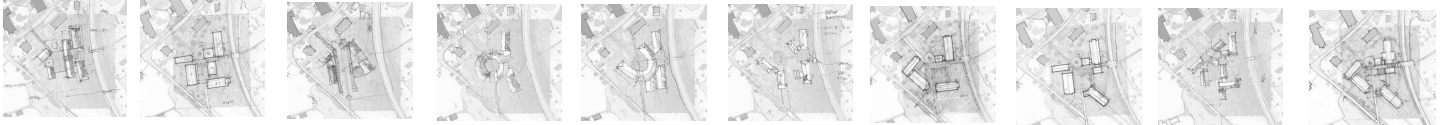

2nd iteration:

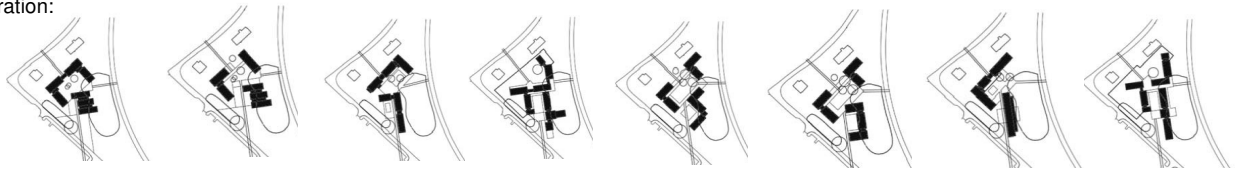

3rd iteration:

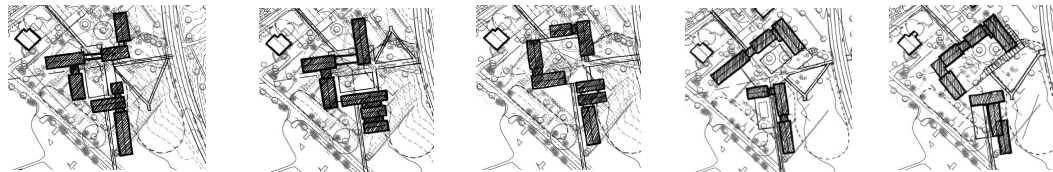

4th iteration:



Proposed site plan:

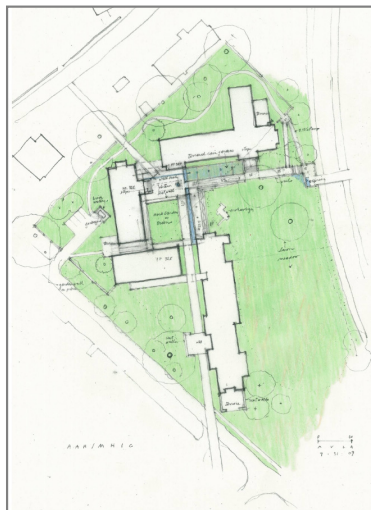

Proposed Site Plan

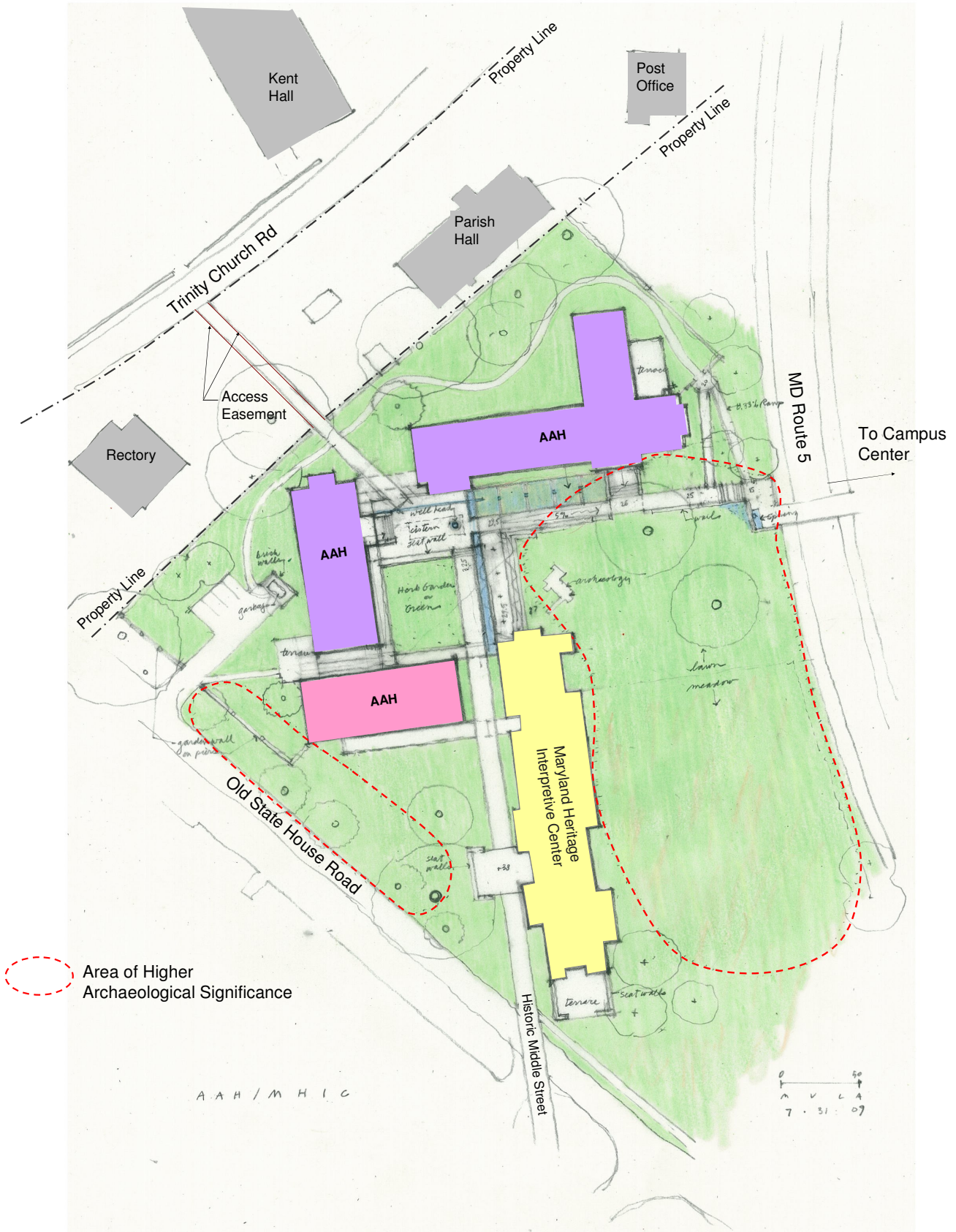

Proposed Parking Plan

The site development will eliminate approximately 110 existing College parking spaces in the Historic Campus. The project will replace these lost spaces and provide increased parking opportunities in Mill Field adjacent to the existing Campus Center parking (lot K).

